**REDEVELOPMENT PLAN
FOR THE
MISSION BAY NORTH REDEVELOPMENT PROJECT**



**SAN FRANCISCO
REDEVELOPMENT AGENCY**

OCTOBER 26, 1998

**REDEVELOPMENT PLAN for the
MISSION BAY NORTH PROJECT AREA**

**Approved and Adopted by
the Board of Supervisors
of the City and County of San Francisco
Ordinance No. 327-98, October 26, 1998**

TABLE OF CONTENTS

| SECTION | PAGE |
|---|-------------|
| 100 INTRODUCTION | 1 |
| 101 Legal Foundation..... | 1 |
| 102 Relationship of Plan to Plan Documents | 1 |
| 103 Redevelopment Project Objectives..... | 2 |
| 104 Planning Objectives and Policies | 3 |
| 200 DESCRIPTION OF THE PLAN AREA | 7 |
| 300 USES PERMITTED IN THE PLAN AREA..... | 8 |
| 301 Redevelopment Land Use Map | 8 |
| 302 Designated Land Uses | 8 |
| 302.1 Mission Bay North Residential | 8 |
| 302.2 Mission Bay North Retail..... | 10 |
| 302.3 Mission Bay North Public Facility | 11 |
| 302.4 Mission Bay North Open Space | 12 |
| 303 Other Land Uses | 12 |
| 303.1 Public Rights-of-Way | 12 |
| 303.2 Other Public and Semi-Public Uses | 12 |
| 303.3 Temporary and Interim Uses | 12 |
| 303.4 Nonconforming Uses..... | 13 |
| 304 General Controls and Limitations | 13 |
| 304.1 Construction | 14 |
| 304.2 Rehabilitation and Retention of Properties | 14 |
| 304.3 Limitation on the Number of Buildings | 14 |
| 304.4 Number of Dwelling Units | 14 |
| 304.5 Limitation on Type, Size and Height of Buildings..... | 14 |
| 304.6 Open Space..... | 14 |
| 304.7 Utilities | 14 |
| 304.8 Nondiscrimination and Nonsegregation..... | 14 |
| 304.9 Fees and Exactions | 15 |
| 305 Variations | 18 |
| 306 Design for Development..... | 19 |
| 400 PROPOSED REDEVELOPMENT ACTIONS | 19 |
| 401 General Redevelopment Actions..... | 19 |

| | |
|--|-----------|
| 402 Participation Opportunities; Extension of Preferences for Reentry Within Redeveloped Plan Area | 20 |
| 402.1 Opportunities for Owners and Business Tenants | 20 |
| 402.2 Rules for Participation Opportunities, Priorities and Preferences..... | 20 |
| 402.3 Owner Participation Agreements | 20 |
| 402.4 Conforming Owners | 20 |
| 402.5 Phasing with Development..... | 21 |
| 403 Cooperation with Public Bodies | 21 |
| 404 Property Acquisition..... | 21 |
| 404.1 Real Property | 21 |
| 404.2 Personal Property..... | 21 |
| 405 Property Management | 22 |
| 406 Relocation of Persons, Business Concerns and Others Displaced by the Project..... | 22 |
| 406.1 Assistance in Finding Other Locations | 22 |
| 406.2 Relocation Payments | 22 |
| 407 Demolition, Clearance, and Building and Site Preparation..... | 22 |
| 407.1 Demolition and Clearance | 22 |
| 407.2 Preparation of Building Sites | 22 |
| 408 Property Disposition and Development..... | 23 |
| 408.1 Real Property Disposition and Development | 23 |
| 408.2 Disposition and Development Documents | 23 |
| 408.3 Development by the Agency | 24 |
| 408.4 Development Plans | 24 |
| 408.5 Personal Property Disposition | 24 |
| 409 Rehabilitation, Conservation and Moving of Structures | 25 |
| 409.1 Rehabilitation and Conservation | 25 |
| 409.2 Moving of Structures | 25 |
| 410 Low-and Moderate-Income Housing | 25 |
| 410.1 Replacement Housing..... | 25 |
| 410.2 Affordable Housing Production | 25 |
| 410.3 Increased and Improved Housing Supply..... | 26 |
| 500 METHODS OF FINANCING THE PROJECT | 27 |
| 501 General Description of the Proposed Financing Method | 27 |
| 502 Tax Increment Funds | 27 |
| 503 Other Loans and Grants..... | 29 |

600 ACTIONS BY THE CITY AND COUNTY29

700 ADMINISTRATION AND ENFORCEMENT.....29

800 PROCEDURE FOR AMENDMENT29

900 SEVERABILITY29

1000 DURATION AND EFFECTIVENESS OF THIS PLAN.....30

ATTACHMENT 1 LAND USE PLAN AND LEGAL DESCRIPTION.....31

ATTACHMENT 2 PLAN AREA MAP.....33

ATTACHMENT 3 REDEVELOPMENT LAND USE MAP.....34

ATTACHMENT 4 PROPOSED PUBLIC IMPROVEMENTS.....35

ATTACHMENT 5 DEFINITIONS.....36

100 INTRODUCTION

All initially capitalized terms shall have the meaning set forth herein, including Section 304.9 and Attachment 5.

101 Legal Foundation

This is the Redevelopment Plan (the “Plan”) for the Mission Bay North Redevelopment Project in the City and County of San Francisco (the “City”), State of California, and consists of the Text, the Legal Description of the Plan Area (Attachment 1), the Plan Area Map (Attachment 2), the Redevelopment Land Use Map (Attachment 3) Proposed Public Improvements (Attachment 4) and Definitions (Attachment 5). This Plan was prepared by the Redevelopment Agency of the City and County of San Francisco (the “Agency”) pursuant to the Community Redevelopment Law of the State of California (Health and Safety Code Section 33000 *et seq.*), the California Constitution and all applicable local laws and ordinances. The Plan is also referred to as the “Mission Bay North Redevelopment Plan.” The Mission Bay North Project Area covered by this Plan is hereinafter referred to as the Plan Area.

The proposed redevelopment of the Plan Area as described in this Plan is consistent with the Central Waterfront Plan, adopted by the Planning Commission of the City and County of San Francisco (the “Planning Commission”) on September 27, 1990, and other applicable elements of the General Plan for the City and County of San Francisco in effect on the effective date of this Plan, and is in conformity with the eight Priority Policies of Section 101.1 of the City Planning Code in effect at the date of adoption of this Plan.

This Plan is based upon a Preliminary Plan formulated and adopted by the Planning Commission by **Motion No. 14255**, on December 12, 1996. It provides the Agency with the powers, duties, and obligations to implement and further the program generally formulated in this Plan for the redevelopment, rehabilitation, and revitalization of the Plan Area. This Plan sets forth the objectives and the basic land use controls within which specific redevelopment activities in the Plan Area will be pursued. This Plan is consistent with provisions of the Community Redevelopment Law in effect on the date of adoption of this Plan.

This Plan and the other Plan Documents, including the Design for Development, shall supersede the San Francisco Planning Code in its entirety.

Regardless of any future action by the City or the Agency, whether by ordinance, resolution, initiative or otherwise, the rules, regulations, and official policies applicable to and governing the overall design, construction, fees, use or other aspect of development of the Plan Area shall be (i) this Plan and the other applicable Plan Documents, (ii) to the extent not inconsistent therewith or not superseded by this Plan, the Existing City Regulations, and (iii) any new or changed City Regulations permitted under this Plan.

102 Relationship of Plan to Plan Documents

This Plan is enacted to establish the powers, duties, and obligations to implement and further the program generally formulated in this Plan. All real property in the Plan Area is

made subject to the controls and requirements of this Plan, and the other applicable Plan Documents.

In order to facilitate the implementation of this Plan, the City and the Agency have entered into the Mission Bay North Interagency Cooperation Agreement (“ICA”). The ICA is intended to provide the framework for cooperation among various City Agencies and the Agency in accordance with the Plan and the other applicable Plan Documents with respect to the review and approval of development authorizations in the Plan Area and, where appropriate, to facilitate cooperation of the City Agencies in issuance of those permits, approvals, agreements and entitlements at each applicable stage of development.

103 Redevelopment Project Objectives

The purposes of the Community Redevelopment Law, which will be attained through, and the major objectives of this Plan are:

- A. Eliminating blighting influences and correcting environmental deficiencies in the Plan Area, including, but not limited to, abnormally high vacancies, abandoned buildings, incompatible land uses, depreciated or stagnant property values, and inadequate or deteriorated public improvements, facilities and utilities.
- B. Assembling land into parcels suitable for modern, integrated development with improved pedestrian and vehicular circulation in the Plan Area.
- C. Replanning, redesigning and developing undeveloped and underdeveloped areas which are improperly utilized.
- D. Providing flexibility in the development of the Plan Area to respond readily and appropriately to market conditions.
- E. Providing opportunities for participation by owners in the redevelopment of their properties.
- F. Strengthening the community’s supply of housing by facilitating economically feasible, affordable housing through installation of needed site improvements and expansion and improvement of the housing supply by the construction of approximately 3,000 very low-, low- and moderate-income and market-rate units, including approximately 600 units of very low-, low- and moderate-income housing.
- G. Strengthening the economic base of the Plan Area and the community by strengthening retail and other commercial functions in the Plan Area through the addition of approximately 500,000 Leasable square feet of retail space.

- H. Facilitating improvement of transportation access to commercial areas, improvement of safety within the Plan Area, and the installation of needed site improvements to stimulate new commercial expansion, employment, and economic growth.
- I. Facilitating public transit opportunities to and within the Plan Area to the extent feasible.
- J. Providing land in an amount of approximately six acres for a variety of publicly accessible open spaces.
- K. Achieving the objectives described above in the most expeditious manner feasible.

104 Planning Objectives and Policies

The Central Waterfront Plan of the San Francisco General Plan sets forth broad land use planning objectives and policies for the entire Central Waterfront, of which Mission Bay North is a part. In addition to the redevelopment objectives listed in Section 103, the following planning objectives and policies provide a more detailed treatment of the basic General Plan objectives and policies for the Plan Area, and will guide the uses permitted in the Plan Area, the construction of facilities therein, and other physical development of the Plan Area. Application of these objectives and policies is a concerted effort to recognize the positive attributes of the City, to enhance and conserve those attributes, and to improve the quality of the living environment based on human needs. This Plan implements the following to the extent feasible:

A. LAND USE

Objective 1 Create a vibrant urban community in Mission Bay North which incorporates a variety of uses including office, business services, retail, entertainment, utility, housing, and recreation and open space.

Policy 1 Consider land use compatibility in siting the various uses.

Policy 2 Integrate Mission Bay North land uses, scale and circulation systems with surrounding districts and San Francisco Bay.

Policy 3 Create a variety of retail and other visitor-serving uses that benefit residents, workers and visitors, including regional retail, entertainment, and recreational uses.

Policy 4 Where appropriate, encourage the siting of ground floor neighborhood-serving retail and personal service uses in locations convenient to serve Mission Bay North businesses, residents, visitors and working populations, and/or encourage the siting of other pedestrian-interest activities along pedestrian pathways, at major intersections and at transit stops.

Policy 5 Where appropriate, design building forms and ground floor uses that enliven and activate streets and open space and which provide visual interaction between building occupants and pedestrians (“eyes on the street”) for safety and security.

Objective 2 Assure that adequate community services and facilities are provided for Mission Bay North residents and working population.

Policy 1 Provide for general community services and recreational facilities at a scale appropriate to serve Mission Bay North.

Policy 2 Include adequate public improvements, utilities and amenities.

B. URBAN DESIGN

Objective 3 Emphasize in Mission Bay North the characteristic San Francisco development patterns, which give its neighborhoods image and means of orientation.

Policy 1 Provide pedestrian scale and interest in ground floor treatments of buildings through the use of treatments such as clear glass fenestration, cornice treatments and detailed facades.

Policy 2 Design in consideration of protecting major views of the Bay, the Bay Bridge and the Downtown skyline from Mission Bay North and, if feasible, the elevated I-280 freeway along Mission Bay South, using street view corridors, open space, the careful placement of building forms and building massing.

Policy 3 Create a visual and physical access to San Francisco Bay and the channel of China Basin.

Policy 4 Recognize that buildings, open spaces and view corridors, seen together, will create the character of Mission Bay North.

Policy 5 Achieve high quality design for buildings and landscaping.

Policy 6 Emphasize the importance of intersections by encouraging higher density uses, taller buildings (one to two stories or the tallest portion of buildings) and architectural variety on street corners.

Policy 7 Avoid extreme contrasts in color, shape and other characteristics, which will cause new buildings to stand out in excess of their public importance.

Objective 4 Create a building form for the Mission Bay North area such that the scale of new development relates to the adjacent waterfront and to adjacent buildings.

Policy 1 Building heights should decrease as they approach the water's edge.

Policy 2 Provide variety in building design within a block to break up the perception of bulk and to achieve a visually interesting streetscape.

C. NEIGHBORHOOD ENVIRONMENT

Objective 5 Develop new residential neighborhoods in consideration of the character and quality of traditional San Francisco neighborhoods.

Policy 1 Create a pattern of buildings built to the front property line so that building facades generally define streets and public places.

Policy 2 As appropriate to the neighborhood, provide on-street parking in the manner typical throughout the City. Limit the amount of curb cut and garage door access to off-street parking in housing blocks.

Policy 3 Whenever possible, orient housing entrances toward the street or walkway.

Policy 4 Screen parking garages at-grade along streets with retail, housing, art elements or landscape treatments.

Policy 5 Encourage social interaction by use of outdoor common areas for horizontal circulation in residential blocks, when feasible.

Policy 6 Provide adequate active outdoor recreation spaces, including passive recreational spaces, and facilities for the area's residential population.

Policy 7 Provide for building security through street orientation of housing, housing design and adequate street lighting.

Policy 8 Provide for pedestrian and open space security through visibility of public spaces and avoid obscured spaces with little sense of proprietorship.

Policy 9 Design buildings in consideration of noise and traffic in the area. Such design can include measures such as placing residential units above a podium of parking or commercial uses, installing double-glazed windows and using sound attenuation construction methods and materials along the traffic-facing walls, placing sleeping quarters away from noise sources, and installing varieties of trees that tolerate traffic impacts.

D. RECREATION AND OPEN SPACE

Objective 6 Provide a variety of open spaces adequate to serve the Mission Bay North community and to augment the City's open space network.

Policy 1 Create parks, open space and recreational facilities within a comfortable walking/wheelchair traveling distance to serve the needs of Mission Bay North residents, workers and visitors of all ages and that are accessible to everyone, including the physically disabled and the elderly.

Policy 2 Create an open space network which provides walking, jogging and bicycle paths between recreation and open space areas throughout Mission Bay North, and provide connections to City-wide pedestrian, bicycle and open space networks, where applicable.

Policy 3 Orient development and parks, public and private open space, and pedestrian areas to facilitate solar access and wind protection for public open space where feasible and consistent with the land uses and intensities contemplated in the Plan.

Policy 4 Enhance parks and open spaces by maintaining view corridors from such areas.

E. COMMERCE AND INDUSTRY

Objective 7 Maintain, enhance and diversify a sound and dynamic economic base for Mission Bay North and the City.

Policy 1 Encourage the siting of retail, multi-media/ telecommunications, recreational, entertainment and public and private utility uses at Mission Bay North in a manner compatible with adjacent uses.

Policy 2 Encourage complementary support services to Mission Bay North such as office, business service and neighborhood-serving retail in order to add to the economic diversity of the area and the City.

Objective 8 Expand employment opportunities in Mission Bay North for San Francisco residents.

Policy 1 Promote the creation of jobs for a highly skilled and professional work force.

Policy 2 Promote efforts to attract, retain and expand employment improvement opportunities for unskilled and semi-skilled workers.

F. TRANSPORTATION

Objective 9 Establish a street system, which is consistent in function and design with the character and use of adjacent land and efficient traffic flow.

Policy 1 Design the Mission Bay North street system in consideration of the layout of surrounding City streets consistent with the Infrastructure Plan for Mission Bay North.

Policy 2 Design the Mission Bay North streets (curb to curb) to the minimum scale necessary to provide required movement, parking, transit, bicycle and access functions.

Policy 3 Establish a truck route system to facilitate truck movements within and through Mission Bay North.

Policy 4 Within a “Transit First” environment, provide parking facilities in consideration of the needs of residents, workers, visitors and their service providers.

Policy 5 Explore opportunities for shared use of parking facilities, both day and night.

Objective 10 Accommodate the expansion of transit services to, from, through and within Mission Bay North.

Policy 1 Work with transit providers to coordinate the siting of transit stops at locations serving high-density uses.

Policy 2 Encourage the siting of shelters, and retail and personal service uses at or near transit stops.

Objective 11 Provide for the safe and convenient use of the bicycle as a means of transportation and recreation.

Objective 12 Provide for convenient, safe, and pleasant pedestrian circulation.

Policy 1 Recognize the importance of the pedestrian environment in the street level design of buildings.

Policy 2 Where appropriate, provide for public pedestrian-dominated streets with limited vehicular access.

Policy 3 Ensure quality street level environments, including street furniture.

Policy 4 Expand and enhance pedestrian access to San Francisco Bay and to the channel of China Basin.

200 DESCRIPTION OF THE PLAN AREA

The boundaries of the Plan Area are described in the “Legal Description of the Plan Area,” attached as Attachment 1 and shown on the “Plan Area Map,” attached as Attachment 2.

300 USES PERMITTED IN THE PLAN AREA

301 Redevelopment Land Use Map

The “Redevelopment Land Use Map,” attached hereto as Attachment 3, illustrates the location of the Plan Area boundaries, major streets within the Plan Area and the proposed land uses to be permitted in the Plan Area.

302 Designated Land Uses

Land uses are permitted in the Plan Area as either principal or secondary uses as provided below. Principal uses shall be permitted in the Plan Area in the particular land use district as set forth in Sections 302.1 through 302.4 of this Plan, in accordance with the provisions of this Plan.

Secondary uses shall be permitted in the Mission Bay North Residential land use district as set forth in Section 302.1, provided that such use generally conforms with redevelopment objectives and planning and design controls established pursuant to this Plan and is determined by the Executive Director to make a positive contribution to the character of the Plan Area, based on a finding of consistency with the following criterion: the secondary use, at the size and intensity contemplated and at the proposed location, will provide a development that is necessary or desirable for, and compatible with, the neighborhood or the community.

302.1 Mission Bay North Residential

The Mission Bay North Residential land use district, shown on the Redevelopment Land Use Map (Attachment 3), consists of residential uses and compatible local-serving retail and other uses which can be in mixed use facilities.

- A. The following principal uses are permitted in the Mission Bay North Residential district:

- Dwelling Units

- Retail Sales and Services:

- Local-Serving Business, excluding Bars, aerobics studios, and dry-cleaning facilities that conduct onsite dry-cleaning operations

- Restaurants

- Automobile Rental

- Arts Activities and Spaces:

- Arts activities in ground floor commercial spaces and/or in Live/Work Units

Office Use:

Local-Serving Business above the ground floor

Home and Business Services:

Catering Establishment
Household and business repair
Interior decorating shop

Other Uses:

Family Child Care Facility
Home Occupation
Live/Work Units
Open Recreation
Outdoor Activity Area
Parking
Automated Teller Machines (ATMs)
Telecommunications antenna and equipment
Installation of tower or antenna for reception of radio and television for
benefit of building occupants

- B. The following secondary uses shall be permitted in the Mission Bay North Residential district if the criteria set forth in this Section 302 are met:

Institutions, including but not limited to:

Local-Serving Child Care Facility
Small residential care facility licensed by the State
Small social service/philanthropic facility
Small vocational/job training facility
Church/religious institution

Retail Sales and Services:

Aerobics studios

Animal Care:

Animal Services in enclosed building

Office Use:

Local-Serving Business on the ground floor

Other Uses:

Walk-Up Facility, except ATMs
Commercial wireless transmitting, receiving or relay facility with
Ambient Electromagnetic Radiation reports if required

302.2 Mission Bay North Retail

The Mission Bay North Retail land use district, shown on the Redevelopment Land Use Map (Attachment 3), consists of primarily retail sales, destination retail, assembly and entertainment with compatible other uses. Residential uses can be in mixed use facilities with compatible retail and other uses.

The following principal uses are permitted in the Mission Bay North Retail district:

Dwelling Units

Institutions, including but not limited to the following:

Local-Serving Child Care Facility
Residential care facility licensed by the State
Social service/philanthropic facility
Vocational/job training facility
Church/religious institution
Clubhouse
Lodge building
Meeting hall

Retail Sales and Services:

All Retail Sales and Services, including Bars and aerobic studios and
excluding dry-cleaning facilities that conduct onsite dry-cleaning
operations
Restaurants
Automobile Rental

Arts Activities and Spaces

Office Use:

Local-Serving Business

Assembly and Entertainment:

Amusement Enterprise
Nighttime Entertainment
Recreation building
Theater

Home and business services:

Catering Establishment
Household and business repair
Interior decorating shop

Automotive:

Automobile service station
Automobile wash

Animal Care:

Animal Services in enclosed building

Other uses:

Family Child Care Facility
Home Occupation
Live/Work Units
Open Recreation
Outdoor Activity Area
Parking
Walk-Up Facility, including ATMs
Commercial wireless transmitting, receiving or relay facility with
required EMR reports
Telecommunications antenna and equipment
Installation of tower or antenna for reception of radio and television for
benefit of building occupants

302.3 Mission Bay North Public Facility

The Mission Bay North Public Facility land use district, shown on the Redevelopment Land Use Map (Attachment 3), consists of land other than housing sites or open space owned by a governmental agency or other public or semi-public entity and in some form of public or semi-public use.

The following principal uses are permitted in the Mission Bay North Public Facility district:

Open lot or enclosed Storage
Pump station
Railroad tracks and related facilities
Other public structure or use

302.4 Mission Bay North Open Space

The Mission Bay North Open Space land use district, shown on the Redevelopment Land Use Map (Attachment 3), consists of a comprehensive system of open spaces, including parks, plazas, and open space corridors. Only recreational uses and uses accessory to and supportive of recreational use are permitted in this district including, but not limited to, accessory parking, kiosks and pushcarts.

303 Other Land Uses

303.1 Public Rights-of-Way

As illustrated on the Redevelopment Land Use Map (Attachment 3) the major public streets within the Plan Area include: Berry Street, King Street, Townsend Street, Third Street, Fourth Street and Fifth Street. Alignments are not exact and are shown on the Redevelopment Land Use Map for illustrative purposes.

Existing streets, alleys and easements may be abandoned, closed or modified as necessary for proper development of the Plan Area. Any changes in the existing street layout within the Plan Area, and in the event that Agency funding is used, outside of the Plan Area, shall be in accordance with the objectives of this Plan.

The public rights-of-way may be used for railroad, vehicular and/or pedestrian traffic, as well as for public improvements, public and private utilities and activities typically found in public rights-of-way. Railroad rights-of-way are allowed in any land use district.

303.2 Other Public and Semi-Public Uses

In any area shown on the Redevelopment Land Use Map (Attachment 3), the Agency is authorized to permit the maintenance, establishment or enlargement of utility easements and boxes and equipment appurtenant thereto. Other permitted public uses are specified in Sections 302.3 and 302.4 of this Plan.

303.3 Temporary and Interim Uses

Pending the ultimate development of land consistent with the land use program described in Attachment 3, certain interim and temporary uses are authorized as follows:

- A. Temporary Uses: The following uses are authorized as of right pursuant to this Plan for a period not to exceed ninety (90) days:

Booth for charitable, patriotic or welfare purposes;
Exhibition, celebration, festival, circus or neighborhood carnival;
Open Air Sales of agriculturally produced seasonal decorations including, but not necessarily limited to, Christmas trees and Halloween pumpkins;
Convention staging;
Parking; and

Truck parking and loading.

- B. Interim Uses: Interim Uses of over ninety (90) days may be authorized for an initial time period to be determined by the Executive Director of the Agency not to exceed fifteen (15) years, upon a determination by the Executive Director that the authorized uses will not impede the orderly development of the Plan Area as contemplated in this Plan. Extensions of this approval period may be authorized by the Executive Director in increments of up to five (5) year periods, subject to the same determination as required for the initial period. Permissible interim uses are as follows:

Rental or sales office incidental to a new development, provided that it be located in the development or a temporary structure;

Structures and uses incidental to environmental cleanup and staging;

Temporary structures and uses incidental to the demolition or construction of a structure, building, infrastructure, group of buildings, or open space, including but not limited to construction staging of materials and equipment;

Storage;

Parking; and

Truck Parking.

303.4 Nonconforming Uses

The Agency shall provide for the reasonable continuance, modification and/or termination of nonconformities as provided in this Section 303.4 to promote compatibility of uses, eliminate blighting conditions and effectuate the purposes, goals, and objectives of this Plan. The Agency shall permit the continuation of existing, nonconforming uses and structures for 15 years after the date of adoption of this plan. The Executive Director is authorized to grant extensions of time if he/she determines that the extension will not impede the orderly development of the Plan Area. No extension shall be for a period in excess of two years. Successive extensions, subject to the same limitations, may be granted upon new application

The Executive Director may authorize additions, alterations, reconstruction, rehabilitation, or changes in use through uses or structures which do not conform to the provisions of this Plan, subject to the same determination as is provided above for extensions of the nonconforming use period.

304 General Controls and Limitations

All real property in the Plan Area is made subject to the controls and requirements of this Plan. No real property shall be developed or rehabilitated after the date of the adoption of this Plan, except in conformance with the provisions of this Plan and the other applicable Plan Documents.

304.1 Construction

All construction in the Plan Area shall comply with the provisions of Section 306 of this Plan, the applicable Plan Documents, and all applicable laws.

304.2 Rehabilitation and Retention of Properties

Any existing structure within the Plan Area approved by the Agency for retention and rehabilitation shall be repaired, altered, reconstructed or rehabilitated in such a manner that it will be safe and sound in all physical respects and be attractive in appearance and not detrimental to the surrounding uses.

304.3 Limitation on the Number of Buildings

The number of Buildings in the Plan Area shall not exceed 200.

304.4 Number of Dwelling Units

The number of Dwelling Units presently in the Plan Area is currently none, and shall be approximately 3,000 under this Plan.

304.5 Limitation on Type, Size and Height of Buildings

The type of Buildings may be as permitted in the Building Code as in effect from time to time. Approximately 500,000 Leasable square feet of retail space should be allowed within the Plan Area. The floor area ratio for Mission Bay North Retail shall be a maximum of 1.1:1, averaged over the entire Mission Bay North Retail land use district, excluding Dwelling Units. Maximum building height within the Plan Area is 160 feet.

In addition to the 500,000 Leasable square feet, a total of up to 5,000 Leasable square feet of Local-Serving retail uses may be constructed on Agency-sponsored affordable housing sites.

304.6 Open Space

Open space to be provided in the Plan Area is the total of all public open spaces and shall be approximately six acres.

304.7 Utilities

All utilities within the Plan Area, and in the event Agency funding is used, outside of the Plan Area, shall be placed underground whenever physically and economically feasible.

304.8 Nondiscrimination and Nonsegregation

There shall be no discrimination or segregation based upon race, color, creed, religion, sex, gender identity, sexual orientation, age, marital or domestic partner status, national origin

or ancestry, or disability including HIV/AIDS status permitted in the sale, lease, sublease, transfer, use, occupancy, tenure or enjoyment of property in the Plan Area.

304.9 Fees and Exactions

The following provisions shall apply to all property in the Plan Area excepting parcels utilized as affordable housing developed by Agency-sponsored utilities:

- A. Definitions: For purposes of this Section 304.9 only, the definitions below shall apply.

Administrative Fee. Any fee charged by any City Agency or the Agency in effect at the time of submission for the processing of any application for Building Permits, subdivision maps, other City regulatory actions or approvals for a Major Phase or Project in the Plan Area that are generally applicable on a City-wide basis for similar land uses.

Art Requirement. The installation and maintenance of works of art costing an amount equal to 1 percent of the hard costs of initial construction (excluding therefrom the costs of Infrastructure and tenant improvements) of a Project for retail or commercial uses exceeding 25,000 gross square feet of floor area prior to the issuance of the first certificate of occupancy or such later time as may be determined by the Agency not to exceed one year thereafter; provided, however, that where the works of art are proposed to be included within an Open Space Parcel, such installation may occur any time prior to completion of the improvements to the Open Space Parcel. Such works may include sculpture, bas-relief, murals, mosaics, decorative water features, fountains, tapestries or other artwork and shall be located in and permanently affixed to a Project, its grounds or an Open Space Parcel or the surrounding area.

Child Care Requirements. The requirements set forth in City Planning Code Section 314.

City-Wide. All privately-owned property within (1) the territorial limits of the City or (2) any designated use district or use classification of the City so long as (a) any such use district or use classification includes more than an insubstantial amount of affected private property other than affected private property within the Plan Area and the Mission Bay South Plan Area, (b) the use district or use classification includes all private property within the use district or use classification that receives the general or special benefits of, or causes the burdens that occasion the need for, the new City Regulation or Development Fees or Exactions, and (c) the cost of compliance with the new City Regulation or Development Fee or Exaction applicable to the same type of use in the Plan Area (or portion thereof) does not exceed the proportional benefits to, or the proportional burdens caused by private development of that type of use in, the Plan Area (or portion thereof).

Development Fees or Exactions. A monetary or other exaction including in-kind contributions, other than a tax or special assessment or Administrative Fee, which is charged by the Agency or any City Agency in connection with any permit, approval, agreement or entitlement for a Major Phase or Project or any requirement for the provision of land for a construction of public facilities or Infrastructure or any requirement to provide or contribute to any public amenity or services. Development Fee or Exaction does not include Building Codes in effect from time to time generally applicable on a City-Wide basis to similar land uses.

Improvements. Buildings, structures, Infrastructure and other work of improvement to be constructed in or for the benefit of the Plan Area.

Infrastructure. Open space (including, among other items, park improvements and restrooms), streets, sewer and storm drainage systems, water systems, street improvements, traffic signal systems, dry utilities, and other Improvements any of which are to be constructed in or for the benefit of the Plan Area.

Major Phase. A development segment comprising one or more of the numbered parcels shown on Attachment 2 (or portions of parcels) included with a numbered parcel or a remaindered parcel if so approved by Agency pursuant to the design review and document approval procedure under an applicable owner participation agreement, containing one or more Projects.

Open Space Parcel. Those parcels or portions thereof designated for use as parks, plazas, or other public open space in Attachment 3 of this Plan.

Project. An individual Building and the related Improvements anticipated to be constructed in connection therewith under this Plan.

School Facilities Impact Fee. The sum payable to the San Francisco Unified School District pursuant to Government Code Section 65995.

B. Administrative Fees: Nothing in this Plan shall preclude or constrain the Agency or any City Agency from charging and collecting an Administrative Fee or any such fee which may be provided for in any owner participation agreement.

C. Development Fees and Exactions:

(i) Existing Development Fees or Exactions. Except as provided in the following provisions of this Section 304.9C, from and so long as this Plan is in effect, the following Development Fees or Exactions as same are in effect as of the date of adoption of this Plan, and only the following, are applicable to the Plan Area: (a) the School Facilities Impact Fee; (b) the Child Care Requirements; and (c) the Art Requirement.

- (ii) New or Increased Development Fees or Exactions. No increase in any Development Fee or Exaction and no new Development Fee or Exaction shall be applicable to the Plan Area for ten (10) years following the effective date of this Plan and, thereafter, shall only be applicable if said new or increased Development Fee or Exaction is generally applicable on a City-Wide basis to similar land uses; provided, however, that any increase in the School Facilities Impact Fee authorized by any change in state law at any time after the approval of this Plan shall apply. Any new or increased Development Fee or Exaction which becomes effective more than ten (10) years following the effective date of the ordinance approving this Plan shall be applicable to the Plan Area so long as such new or increased Development Fee or Exaction is (i) generally applicable on a City-Wide basis to similar land uses and (ii) not redundant as to the initial Project of a fee, dedication, program, requirement or facility described in the applicable Plan Documents related to (A) affordable housing or (B) open space.

Notwithstanding the foregoing, new or increased Development Fees or Exactions may be imposed in order to comply with changes in applicable federal or state law or regulations as further provided in Subsection 304.9C(iii); provided, however, that any such new or increased Development Fee or Exaction shall be applied to the Plan Area on a Project by Project basis in a manner which is proportional to the impacts caused by the development in the Plan Area; that is, any such Development Fee or Exaction shall be no more than the equitable share of the cost of funding reasonable compliance with the applicable federal or state law or regulation taking into account the equitable amount allocable to the impacts caused by previous or existing development within the City. In no event shall any Project within the Plan Area be required to pay a new or increased Development Fee or Exaction in connection with compliance with any such federal or state law or regulation which is not applied on a City-Wide basis to similar land uses.

- (iii) Protection of Public Health and Safety. Notwithstanding any provision of this Section 304.9C to the contrary, the Agency and any City Agency having jurisdiction, shall exercise its discretion under this Plan and the other applicable Plan Documents in a manner which is consistent with the public health, safety and welfare and shall retain, at all times, its and their respective authority to take any action that is necessary to protect the physical health and safety of the public including without limitation authority to condition or deny a permit, approval, agreement or other entitlement or to change or adopt any new City Regulation if required (a) to protect the physical health or safety of the residents in the Plan Area, the adjacent community or the public, or (b) to comply with applicable federal or state law or regulations including without limitation changes in Existing City Regulations

reasonably calculated to achieve new, more restrictive federal or state attainment or other standards applicable to the City for water quality, air quality, hazardous materials or otherwise relating to the physical environment where such City Regulations are generally applicable and proportionally applied to similar land uses on a City-Wide basis but subject, in all events, to any rights to terminate any owner participation agreement between an owner and the Agency as set forth in the applicable Plan Documents. Except for emergency measures, any City Agency or the Agency, as the case may be, will meet and confer with the owner in advance of the adoption of such measures to the extent feasible, provided, however, that said City Agency and the Agency shall each retain the sole and final discretion with regard to the adoption of any new City Regulation in furtherance of the protection of the physical health and safety of the public as provided in this Subsection 304.9C(iii).

- (iv) Nonconflicting Laws. In addition to the reservation set forth in Section 304.9C(iii), the City Agencies and the Agency reserve the right to impose any new City Regulations and any changes to the Existing City Regulations (except for sections of the Planning Code superceded by this Plan) that do not conflict with the development allowed by this Plan and the other applicable Plan Documents. As used herein, “conflict” means any proposed new or changed City Regulations which preclude or materially increase the cost of performance of or compliance with any provision of this Plan or the applicable Plan Documents or do any of the following: alter the permitted uses of land; decrease the maximum building height of buildings; reduce the density or intensity of development permitted; delay development; limit or restrict the availability of Infrastructure; impose limits or controls on the timing, phasing or sequencing of development; or modify Development Fees or Exactions except as permitted by this Section 304.9C. Notwithstanding the foregoing, the City may apply its then current standards for Infrastructure pursuant to then applicable City Regulations. Nothing in this Plan or the other applicable Plan Documents shall be deemed to limit any City Agency’s or the Agency’s ability to comply with the California Environmental Quality Act (“CEQA”).

305 Variations

The Agency may modify the land use controls in this Plan where, owing to unusual and special conditions, enforcement would result in undue hardships or would constitute an unreasonable limitation beyond the intent and purposes of these provisions. Upon written request for variation from the Plan’s land use provisions from the owner of the property, which states fully the grounds of the application and the facts pertaining thereto, and upon its own further investigation, the Agency may, in its sole discretion, grant such variation from the requirements and limitations of this Plan. The Agency shall find and determine that the variation results in substantial compliance with the intent and purpose of this Plan, provided that in no instance will any variation be granted that will change the land uses of this Plan.

306 Design for Development

Within the limits, restrictions and controls established in this Plan, the Agency is authorized to establish height limits of buildings, land coverage, density, setback requirements, design and sign criteria, traffic circulation and access standards, and other development and design controls necessary for proper development of both private and public areas within the Plan Area, as set forth in the Design for Development.

400 PROPOSED REDEVELOPMENT ACTIONS

401 General Redevelopment Actions

The Agency proposes to achieve the objectives of Sections 103 and 104 and effectuate the policies of Section 104 of this Plan by:

- A. The acquisition of real property;
- B. The demolition or removal of certain buildings and improvements;
- C. The provision for participation in redevelopment by owners presently located in the Plan Area and the extension of preferences to business occupants and other tenants desiring to remain or relocate within the redeveloped Plan Area;
- D. The management of any property acquired by and under the ownership or control of the Agency;
- E. The provision of relocation assistance to eligible occupants displaced from property in the Plan Area;
- F. The installation, construction, purchase or reconstruction of streets, utilities, parks, other open spaces, and other public improvements;
- G. The disposition of property for uses in accordance with this Plan;
- H. The redevelopment of land by private enterprise or public agencies for uses in accordance with this Plan and to promote economic development of the area;
- I. The rehabilitation of structures and improvements by present owners, their successors and the Agency;
- J. The assembly of adequate sites for the development and construction of residential, commercial or industrial facilities; and
- K. Provision for very low-, low- and moderate-income housing.

To accomplish the above activities in the implementation and furtherance of this Plan, the Agency is authorized to use all the powers provided in this Plan and all the powers now or hereafter permitted by law.

402 Participation Opportunities; Extension of Preferences for Reentry Within Redeveloped Plan Area

402.1 Opportunities for Owners and Business Tenants

In accordance with this Plan and the rules for participation by owners and the extension of preferences to business tenants adopted by the Agency pursuant to this Plan and the Community Redevelopment Law, persons who are owners of real property in the Plan Area shall be given a reasonable opportunity to participate in redevelopment by: (1) retaining all or a portion of their properties and developing or improving such property for use in accordance with this Plan; (2) acquiring adjacent or other properties within the Plan Area and developing or improving such property for use in accordance with this Plan; or (3) selling their properties to the Agency and purchasing other properties in the Plan Area.

The Agency shall extend reasonable preferences to persons who are engaged in business in the Plan Area to participate in the redevelopment of the Plan Area, or to reenter into business within the redeveloped Plan Area, if they otherwise meet the requirements of this Plan.

402.2 Rules for Participation Opportunities, Priorities and Preferences

In order to provide opportunities to owners to participate in the redevelopment of the Plan Area and to extend reasonable preferences to businesses to reenter into business within the redeveloped Plan Area, the Agency has promulgated rules for participation by owners and the extension of preferences to business tenants for reentry within the redeveloped Plan Area.

402.3 Owner Participation Agreements

The Agency shall require as a condition to participation in redevelopment that each participant enter into a binding agreement with the Agency by which the participant agrees to rehabilitate, develop, use and maintain the property in conformance with this Plan and to be subject to its provisions.

Whether or not a participant enters into an owner participation agreement with the Agency, all other provisions of this Plan are applicable to all public and private property in the Plan Area.

In the event that a participant fails or refuses to rehabilitate, develop and use and maintain its real property pursuant to this Plan and the owner participation agreement, the real property or any interest therein may be acquired by the Agency and sold or leased for rehabilitation or development in accordance with this Plan.

402.4 Conforming Owners

Subject to any owner participation agreement provisions, the Agency may determine in its sole and absolute discretion, that certain real property within the Plan Area meets the

requirements of this Plan, and the owner of such property will be permitted to remain as a conforming owner without an owner participation agreement with the Agency, provided such owner continues to operate, use and maintain the real property within the requirements of this Plan. However, a conforming owner shall be required by the Agency to enter into an owner participation agreement with the Agency in the event that such owner desires to: (a) construct any additional improvements or substantially alter or modify existing structures on any of the real property described above as conforming; or (b) acquire additional contiguous property within the Plan Area.

402.5 Phasing with Development

Subject to the terms of owner participation agreements, owners shall be required to provide for infrastructure, affordable housing and open space in conjunction with development of improvements in the Plan Area.

403 Cooperation with Public Bodies

The Agency is authorized to financially (and otherwise) assist any public entity in the cost of public land, buildings, facilities, structures or other improvements (within or without the Plan Area) which land, buildings, facilities, structures or other improvements are or would be of benefit to the Plan Area, in accordance with the ICA.

404 Property Acquisition

404.1 Real Property

The Agency may acquire real property located in the Plan Area by any means authorized by law.

It is in the public interest and necessary in order to eliminate the conditions requiring redevelopment and in order to implement this Plan for the power of eminent domain to be employed by the Agency to acquire real property in the Plan Area which cannot be acquired by gift, devise, exchange, purchase or any other lawful method, except that the Agency is not authorized to employ the power of eminent domain to acquire property on which any persons legally reside. Eminent domain proceedings, if used, must be commenced within twelve (12) years from the date the ordinance adopting this Plan becomes effective.

The Agency is authorized to acquire structures without acquiring the land upon which those structures are located. The Agency is authorized to acquire either the entire fee or any other interest in real property less than a fee.

404.2 Personal Property

Where necessary to implement this Plan, the Agency is authorized to acquire personal property in the Plan Area by any lawful means, including eminent domain.

405 Property Management

During such time as property, if any, in the Plan Area is owned or leased by the Agency, such property shall be under the management and control of the Agency. Such property may be rented or leased by the Agency, and such rental or lease shall be pursuant to such policies as the Agency may adopt.

406 Relocation of Persons, Business Concerns and Others Displaced by the Project

406.1 Assistance in Finding Other Locations

The Agency shall assist or cause to be assisted all eligible persons (including individuals and families), business concerns and others displaced from the Plan Area pursuant to this Plan in finding other locations and facilities, as may be required by law. In order to implement this Plan with a minimum of hardship to eligible persons, business concerns and others, if any, displaced by implementation of this Plan, the Agency shall assist such persons, business concerns and others in finding new locations in accordance with all applicable relocation statutes and regulations (Section 33410 et seq. of the Community Redevelopment Law).

406.2 Relocation Payments

The Agency shall make or cause to be made relocation payments to persons (including individuals and families), business concerns and others displaced by implementation of this Plan as may be required by law. Such relocation payments shall be made pursuant to the California Relocation Assistance Law (Government Code Section 7260 et seq.), Agency rules and regulations adopted pursuant thereto, and as may be applicable in the event that federal funding is used in the implementation of this Plan, in accordance with the Uniform Relocation Assistance and Real Property Acquisition Policies Act of 1970, as amended. The Agency may make such other payments as it determines to be appropriate and for which funds are available.

407 Demolition, Clearance, and Building and Site Preparation

407.1 Demolition and Clearance

The Agency is authorized to demolish and clear buildings, structures and other improvements from any real property in the Plan Area owned or leased by the Agency or other public entity as necessary to carry out the purposes of this Plan.

407.2 Preparation of Building Sites

The Agency is authorized to prepare, or cause to be prepared, as building sites, any real property in the Plan Area owned or leased by the Agency or other public entity. In connection therewith, the Agency may cause, provide for, or undertake the installation or construction of streets, utilities, parks, playgrounds and other public improvements necessary to carry out this Plan. The Agency is also authorized to construct foundations, platforms and other structural

forms necessary for the provision or utilization of air rights sites for buildings to be used for residential, commercial, public and other uses provided in this Plan.

408 Property Disposition and Development

408.1 Real Property Disposition and Development

For the purposes of this Plan, the Agency is authorized to sell, lease, exchange, subdivide, transfer, assign, pledge, encumber by mortgage or deed of trust or otherwise dispose of any interest in real property. To the extent permitted by law, the Agency is authorized to dispose of or acquire real property by negotiated lease, sale or transfer without public bidding. Property containing buildings or structures rehabilitated by the Agency shall be offered for resale within one (1) year after completion of rehabilitation or an annual report concerning such property shall be published by the Agency as required by law.

Real property acquired by the Agency may be conveyed by the Agency without charge to the City and, where beneficial to the Plan Area, without charge to any public body. All real property acquired by the Agency in the Plan Area shall be sold or leased to public or private persons or entities for development for the uses permitted in this Plan, or may be developed by the Agency for public uses.

All purchasers or lessees of property acquired from the Agency shall be made obligated to use the property for the purposes designated in this Plan, to begin and complete development of the property within a period of time which the Agency fixes as reasonable and to comply with other conditions which the Agency deems necessary to carry out the purposes of this Plan.

408.2 Disposition and Development Documents

To provide adequate safeguards to ensure that the provisions of this Plan will be carried out and to prevent the recurrence of blight, all real property sold, leased or conveyed by the Agency, as well as all property subject to owner participation agreements, is subject to the provisions of this Plan.

The Agency shall reserve such powers and controls in the disposition and development documents as may be necessary to prevent transfer, retention or use of property for speculative purposes and to ensure that development is carried out pursuant to this Plan.

Leases, deeds, contracts, agreements and declarations of restrictions of the Agency may contain restrictions, covenants, covenants running with the land, rights of reverter, conditions subsequent, equitable servitudes or any other provisions necessary to carry out this Plan. Where appropriate, as determined by the Agency, such documents, or portions thereof, shall be recorded in the office of the County Recorder.

All property in the Plan Area is hereby subject to the restriction that there shall be no discrimination or segregation based upon race, color, creed, religion, sex, gender identity, sexual orientation, age, marital or domestic partner status, national origin or ancestry, or disability including HIV/AIDS status permitted in the sale, lease, sublease, transfer, use,

occupancy, tenure or enjoyment of property in the Plan Area. All property sold, leased, conveyed or subject to a participation agreement shall be expressly subject by appropriate documents to the restriction that all deeds, leases or contracts for the sale, lease, sublease or other transfer of land in the Plan Area shall contain such nondiscrimination and nonsegregation clauses.

408.3 Development by the Agency

To the extent now or hereafter permitted by law, the Agency is authorized to pay for, develop or construct any publicly-owned building, facility, structure or other improvement either within or without the Plan Area, for itself or for any public body or entity, which buildings, facilities, structures or other improvements are or would be of benefit to the Plan Area. Specifically, the Agency may pay for, install or construct the buildings, facilities, structures and other improvements, and may acquire or pay for the land and site preparation required therefore.

In addition to the public improvements authorized under this Section 408 and the specific publicly-owned improvements, the Agency is authorized to install and construct, or to cause to be installed and constructed, within or without the Plan Area, for itself or for any public body or entity for the benefit of the Plan Area, public improvements and public utilities, including, but not limited to, those described in Attachment 4.

The Agency is authorized to install and construct or cause to be installed and constructed temporary public improvements necessary to carry out this Plan. Temporary public improvements may include, but are not limited to, parks, streets, and utilities. Temporary utilities may be installed above ground only with the written approval of the Agency.

The Agency may enter into contracts, leases and agreements with the City or other public body or entity pursuant to this Section 408.3, and the obligation of the Agency under such contract, lease or agreement shall constitute an indebtedness of the Agency which may be made payable out of the taxes levied in the Plan Area and allocated to the Agency under subdivision (b) Section 33670 of the Community Redevelopment Law, Section 502 of this Plan or out of any other available funds.

408.4 Development Plans

All private development plans shall be submitted to the Agency for approval and architectural review consistent with the Plan and the other applicable Plan Documents. All public development plans shall be in accordance with the Plan and any applicable Plan Documents.

408.5 Personal Property Disposition

For the purposes of this Plan, the Agency is authorized to lease, sell, exchange, transfer, assign, pledge, encumber or otherwise dispose of personal property which is acquired by the Agency.

409 Rehabilitation, Conservation and Moving of Structures

409.1 Rehabilitation and Conservation

The Agency is authorized to rehabilitate and conserve or to cause to be rehabilitated and conserved, any building or structure in the Plan Area owned by the Agency. The Agency is also authorized and directed to advise, encourage and assist in the rehabilitation and conservation of property in the Plan Area not owned by the Agency. The Agency is also authorized to acquire, restore, rehabilitate, move and conserve buildings of historic or architectural significance.

It shall be the purpose of this Plan to encourage the retention of existing businesses that are generally compatible with proposed developments in the Plan Area and in conformity with the uses permitted in this Plan, and to add to the economic viability of such businesses by programs that encourage voluntary participation in conservation and rehabilitation. The Agency is authorized to conduct a program of assistance and incentives to encourage owners of property within the Plan Area to upgrade and maintain their property in a manner consistent with the Plan and with other standards that may be established by the Agency for the Plan Area.

409.2 Moving of Structures

As necessary in carrying out this Plan, the Agency is authorized to move, or to cause to be moved, any structure or building which can be rehabilitated to a location within or outside the Plan Area.

410 Low-and Moderate-Income Housing

410.1 Replacement Housing

In accordance with Section 33334.5 of the Community Redevelopment Law, whenever dwelling units housing persons and families of low or moderate income are destroyed or removed from the low and moderate income housing market as part of implementation of this Plan, the Agency shall, within four (4) years of such destruction or removal, rehabilitate, develop or construct, or cause to be rehabilitated, developed or constructed, for rental or sale to persons and families of low or moderate income an equal number of replacement dwelling units at affordable rents within the Plan Area or within the territorial jurisdiction of the City in accordance with all of the provisions of Sections 33413 and 33413.5 of the Community Redevelopment Law.

410.2 Affordable Housing Production

In accordance with subdivision (b) of Section 33413 of the Community Redevelopment Law, at least 15 percent of all new or rehabilitated dwelling units developed within the Plan Area by public or private entities or persons other than the Agency, shall be available at affordable housing cost to persons and families of very low, low or moderate income. Not less than 40 percent of the dwelling units required to be available at affordable housing cost to

persons and families of very low, low or moderate income shall be available at affordable housing cost to very low income households.

At least 30 percent of all new or rehabilitated dwelling units developed by the Agency shall be available at affordable housing cost to persons and families of very low, low or moderate income. Not less than 50 percent of these dwelling units shall be available at affordable housing cost to, and occupied by, very low income households.

410.3 Increased and Improved Housing Supply

Pursuant to Section 33334.2 of the Community Redevelopment Law, not less than twenty percent (20%) of all taxes which are allocated to the Agency pursuant to subdivision (b) of Section 33670 of the Community Redevelopment Law and Section 502 of this Plan shall be used by the Agency for the purposes of increasing, improving and preserving the City's supply of housing for persons and families of very low, low or moderate income unless certain findings are made as required by that section to lessen or exempt such requirement. In carrying out this purpose, the Agency may exercise any or all of its powers, including the following:

- A. Acquire land or building sites;
- B. Improve land or building sites with on-site or off-site improvements;
- C. Donate land to private or public persons or entities;
- D. Finance insurance premiums pursuant to Section 33136 of the Community Redevelopment Law;
- E. Construct buildings or structures;
- F. Provide subsidies to or for the benefit of persons or families of very low, low or moderate income;
- G. Develop plans, pay principal and interest on bonds, loans, advances or other indebtedness or pay financing or carrying charges;
- H. Preserve the availability of affordable housing units which are assisted or subsidized by public entities and which are threatened with conversion to market rates;
- I. Require the integration of affordable housing sites with sites developed for market rate housing;
- J. Assist the development of housing by developers.

The Agency may use the funds specified in this Section to meet, in whole or in part, the replacement housing provisions in Section 410.1 or the affordable housing production provisions in Section 410.2 above. These funds may be used inside the Plan Area, or outside

the Plan Area only if findings of benefit to the Plan Area are made as required by said Section 33334.2 of the Community Redevelopment Law.

500 METHODS OF FINANCING THE PROJECT

501 General Description of the Proposed Financing Method

The Agency is authorized to finance the implementation of this Plan with financial assistance from the City, State of California, federal government, tax increment funds, interest income, Agency bonds, donations, loans from private financial institutions, assessments, the lease or sale of Agency-owned property or any other available source, public or private.

The Agency is also authorized to obtain advances, borrow funds and create indebtedness in carrying out this Plan. The principal and interest on such advances, funds and indebtedness may be paid from tax increments or any other funds available to the Agency.

The City or any other public agency may expend money to assist the Agency in carrying out this Plan. As available, gas tax funds from the state and county may be used for street improvements and public transit facilities.

502 Tax Increment Funds

All taxes levied upon taxable property within the Plan Area each year, by or for the benefit of the State of California, the City, any district or any other public corporation (hereinafter sometimes called "taxing agencies") after the effective date of the ordinance approving this Plan, shall be divided as follows:

- A. That portion of the taxes which would be produced by the rate upon which the tax is levied each year by or for each of said taxing agencies upon the total sum of the assessed value of the taxable property in the Plan Area as shown upon the assessment roll used in connection with the taxation of such property by such taxing agencies, last equalized prior to the effective date of such ordinance, shall be allocated to and when collected shall be paid into the funds of the respective taxing agencies as taxes by or for said taxing agencies on all other property are paid (for the purpose of allocating taxes levied by or for any taxing agency or agencies which does not include the territory of the Plan Area on the effective date of such ordinance but to which such territory is annexed or otherwise included after such effective date, the assessment roll of the County of San Francisco last equalized on the effective date of said ordinance shall be used in determining the assessed valuation of the taxable property in the Plan Area on said effective date).
- B. Except as provided in subdivision (e) of Section 33670 or in Section 33492.15 of the Community Redevelopment Law, that portion of said levied taxes each year in excess of such amount shall be allocated to and, when collected, shall be paid into a special fund of the Agency to pay the principal of and interest on loans, monies advanced to or indebtedness (whether funded, refunded, assumed

or otherwise) incurred by the Agency to finance or refinance, in whole or in part, the implementation of this Plan. Unless and until the total assessed valuation of the taxable property in the Plan Area exceeds the total assessed value of taxable property in the Plan Area as shown by the last equalized assessment roll referred to in subdivision A hereof, all of the taxes levied and collected upon the taxable property in the Plan Area shall be paid into the funds of the respective taxing agencies. When said loans, advances indebtedness, if any, and interest thereon, have been paid, all monies thereafter received from taxes upon the taxable property in the Plan Area shall be paid into the funds of the respective taxing agencies as taxes on all other property are paid.

The portion of taxes mentioned in Section 502B above are hereby irrevocably pledged for the payment of the principal of and interest on the advance of monies, or making of loans or the incurring of any indebtedness (whether funded, refunded, assumed or otherwise) by the Agency to finance or refinance the implementation of this Plan in whole or in part, including but not limited to direct and indirect expenses. The Agency is authorized to make such pledges as to specific advances, loans and indebtedness as appropriate in carrying out this Plan.

The Agency is authorized to issue bonds from time to time, if it deems appropriate to do so, in order to finance all or any part of the implementation of this Plan. Neither the members of the Agency nor any persons executing the bonds are liable personally on the bonds by reason of their issuance.

The amount of bonded indebtedness of the Agency to be repaid from the allocation of taxes to the Agency pursuant to Section 33670 of the Community Redevelopment Law, which can be outstanding at one time, shall not exceed \$190,000,000, except by amendment of this Plan.

The bonds and other obligations of the Agency are not a debt of the City or the State, nor are any of its political subdivisions liable for them, nor in any event shall the bonds or obligations be payable out of any funds or properties other than those of the Agency, and such bonds and other obligations shall so state on their face. The bonds do not constitute indebtedness within the meaning of any constitutional or statutory debt limitation or restriction.

The Agency shall not establish or incur loans, advances or indebtedness to finance in whole or in part the Project beyond twenty (20) years from the effective date of the ordinance adopting this Plan unless amended following applicable provisions of the Community Redevelopment Law, except that the Agency may incur loans, advances or indebtedness beyond twenty (20) years from the effective date of the ordinance adopting this Plan to be paid from the Low and Moderate Income Housing Fund as defined by the Community Redevelopment Law or to meet the Agency's replacement housing or inclusionary housing requirements as set forth in Sections 33413 and 33413.5 of the Community Redevelopment Law. This limit shall not prevent the Agency from refinancing, refunding, or restructuring indebtedness after the time limit if the indebtedness is not increased and the time during which the indebtedness is to be repaid is not extended beyond the time limit to repay indebtedness required by Section 33333.2 of the Community Redevelopment Law.

The Agency shall not pay indebtedness or receive property taxes pursuant to Section 33670 from the Plan Area after forty-five (45) years from the effective date of the ordinance adopting this Plan.

503 Other Loans and Grants

Any other loans, grants, guarantees or financial assistance from the United States government, the State of California or any other public or private source will be used if available.

600 ACTIONS BY THE CITY AND COUNTY

The City shall aid and cooperate with the Agency in carrying out this Plan and shall take all actions necessary to ensure the continued fulfillment of the purposes of this Plan and the other applicable Plan Documents, including preventing the recurrence or spread of conditions causing blight in the Plan Area, pursuant to the ICA.

700 ADMINISTRATION AND ENFORCEMENT

Except as otherwise specified in Section 600 above, the administration and enforcement of this Plan, including the preparation and execution of any documents implementing this Plan, shall be performed by the Agency.

The provisions of this Plan or other documents entered into pursuant to this Plan may also be enforced by legal action instituted by the Agency to seek appropriate remedy, except as may be limited by owner participation agreements. Such remedies may include, but are not limited to, specific performance, damages, reentry, injunctions or any other remedies appropriate to the purposes of this Plan. In addition, any recorded provisions, which are expressly for the benefit of owners of property in the Plan Area, may be enforced by such owners.

800 PROCEDURE FOR AMENDMENT

This Plan may be amended by means of the procedure established in Sections 33450-33458 of the Community Redevelopment Law or by any other procedure hereafter established by law.

900 SEVERABILITY

If any provision, section, subsection, subdivision, sentence, clause or phrase of the Plan is for any reason held to be invalid or unconstitutional, such decision shall not affect the validity of the remaining portion or portions of the Plan.

1000 DURATION AND EFFECTIVENESS OF THIS PLAN

The Provisions of this Plan shall be effective for thirty (30) years from the date of adoption of this Plan by the Board of Supervisors, except that the nondiscrimination and nonsegregation provisions shall run in perpetuity. After this time limit on the duration and effectiveness of the plan, the Agency shall have no authority to act pursuant to this Plan except to pay previously incurred indebtedness and to enforce existing covenants or contracts, and, except that, if the Agency has not completed its housing obligations pursuant to Section 33413 of the Community Redevelopment Law, it shall retain its authority to implement its requirements under Section 33413, including its ability to incur and pay indebtedness for this purpose, and shall use this authority to complete these housing obligations as soon as reasonably possible.

ATTACHMENT 1

LAND USE PLAN AND LEGAL DESCRIPTION

All that certain real property situate in the City and County of San Francisco, State of California, more particularly described as follows:

Commencing at the intersection of the northeasterly line of Sixth Street (82.50 feet wide) with the southeasterly line of Berry Street (82.50 feet wide), said intersection having a coordinate of North 468817.32, East 141868.98 in the California Coordinate System of 1927 Zone 3; thence along said southeasterly line of Berry Street north 46 18' 07" east 2641.66 feet to the southwesterly line of Third Street (82.50 feet wide) said point being on the westerly boundary line of the current survey area; thence along said southwesterly line of Third Street north 43 41' 53" west 392.50 feet to a point on the northwesterly line of King Street (158 feet wide) said point being the true point of beginning; thence along said southwesterly line of Third Street, south 43 41' 53" east 392.50 feet to the southeasterly line of Berry Street (82.50 feet wide); thence leaving said westerly boundary line, and running along said southeasterly line of Berry Street south 46 18' 07" west 825.95 feet to the northeasterly line of Fourth Street (82.50 feet wide); thence along said northeasterly line of Fourth Street south 43 41' 53" east 240.00 feet to the northeasterly prolongation of the northwesterly line of Channel Street (200.00 feet wide); thence along said northeasterly prolongation of Channel Street, and the southwesterly prolongation thereof, south 46 18' 07" west 2612.57 feet to a point on a line that is parallel with and distant northeasterly 110.69 feet, measured at a right angle, from the northeasterly line of Seventh Street (82.50 feet wide); thence along said parallel line south 43 41' 53" east 200.00 feet to the southwesterly prolongation of the southeasterly line of Channel Street; thence along last said southwesterly prolongation south 46 18' 07" west 193.19 feet to the southwesterly line of Seventh Street; thence along said southwesterly line of Seventh Street north 43 41' 53" west 1190.00 feet to the northwesterly line of Townsend Street (82.50 feet wide); thence along said northwesterly line of Townsend Street north 46 18' 07" east 990.06 feet to the northeasterly line of Sixth Street (82.50 feet wide); thence along said northeasterly line of Sixth Street south 43 41' 53" east 82.50 feet to the southeasterly line of Townsend Street; thence along said southeasterly line of Townsend Street south 46 18' 07" west 82.50 feet to the southwesterly line of Sixth Street; thence along said southwesterly line of Sixth Street south 43 41' 53" east 275.00 feet; thence north 46 18' 07" east 82.50 feet to the northeasterly line of Sixth Street (81.50 feet wide); thence along last said northeasterly line of Sixth Street south 43 41' 53" east 90.33 feet; thence north 24 31' 18" east 186.53 feet to the beginning of a tangent curve, concave to the southeast, having a radius of 672.00 feet; thence northerly and northeasterly along said curve 255.45 feet, through a central angle of 21 46' 49"; thence north 46 18' 07" east 63.42 feet; thence north 51 53' 27" east 275.69 feet to said northwesterly line of King Street; thence along said northwesterly line of King Street north 47 18' 07" east 972.85 feet to the southwesterly line of said Fourth Street; thence along said southwesterly line of Fourth Street north 43 41' 53" west 357.50 feet to said northwesterly line of Townsend Street; thence along said northwesterly line of Townsend Street north 46 18' 07" east 990.95 feet to the northeasterly line of Third Street; thence along said northeasterly line of Third Street south 43 41' 53" east 357.50 feet to a point on said northeasterly line of King Street, last said point being on said westerly boundary line of said survey area; thence along said westerly boundary

line, being also the said northwesterly line of King Street south 46 18' 07" west 82.50 feet to the true point of beginning.

Containing 2,821,489 square feet, more or less.

The bearings used in the above description are on the California Coordinate System of 1927, Zone 3. Multiply the above distances by 0.999928 to obtain grid distances.

ATTACHMENT 2

PLAN AREA MAP

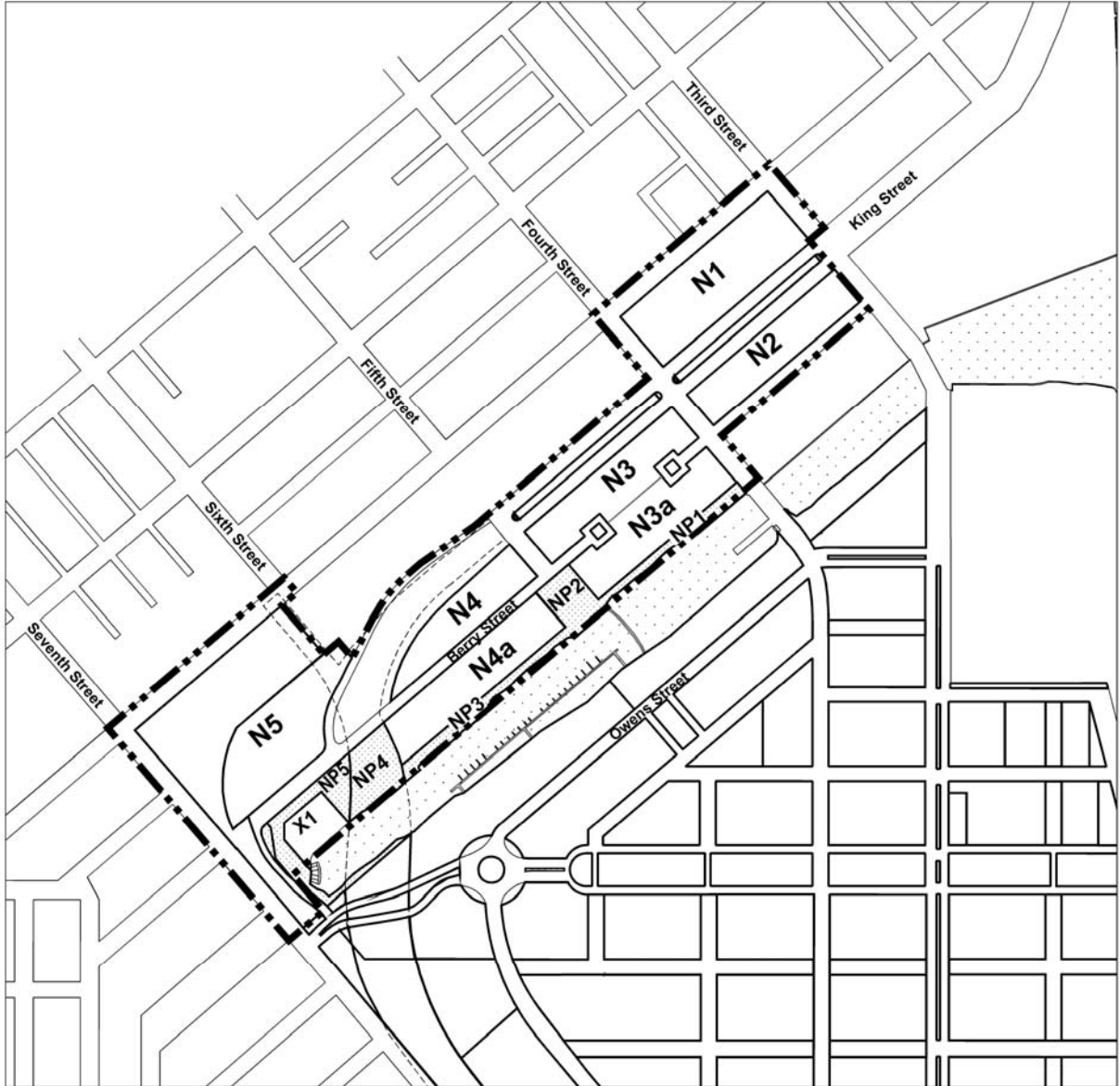

Note: Street alignments and open space configurations shown on the figure are not exact and are indicated for illustrative purposes.

ATTACHMENT 3

REDEVELOPMENT LAND USE MAP

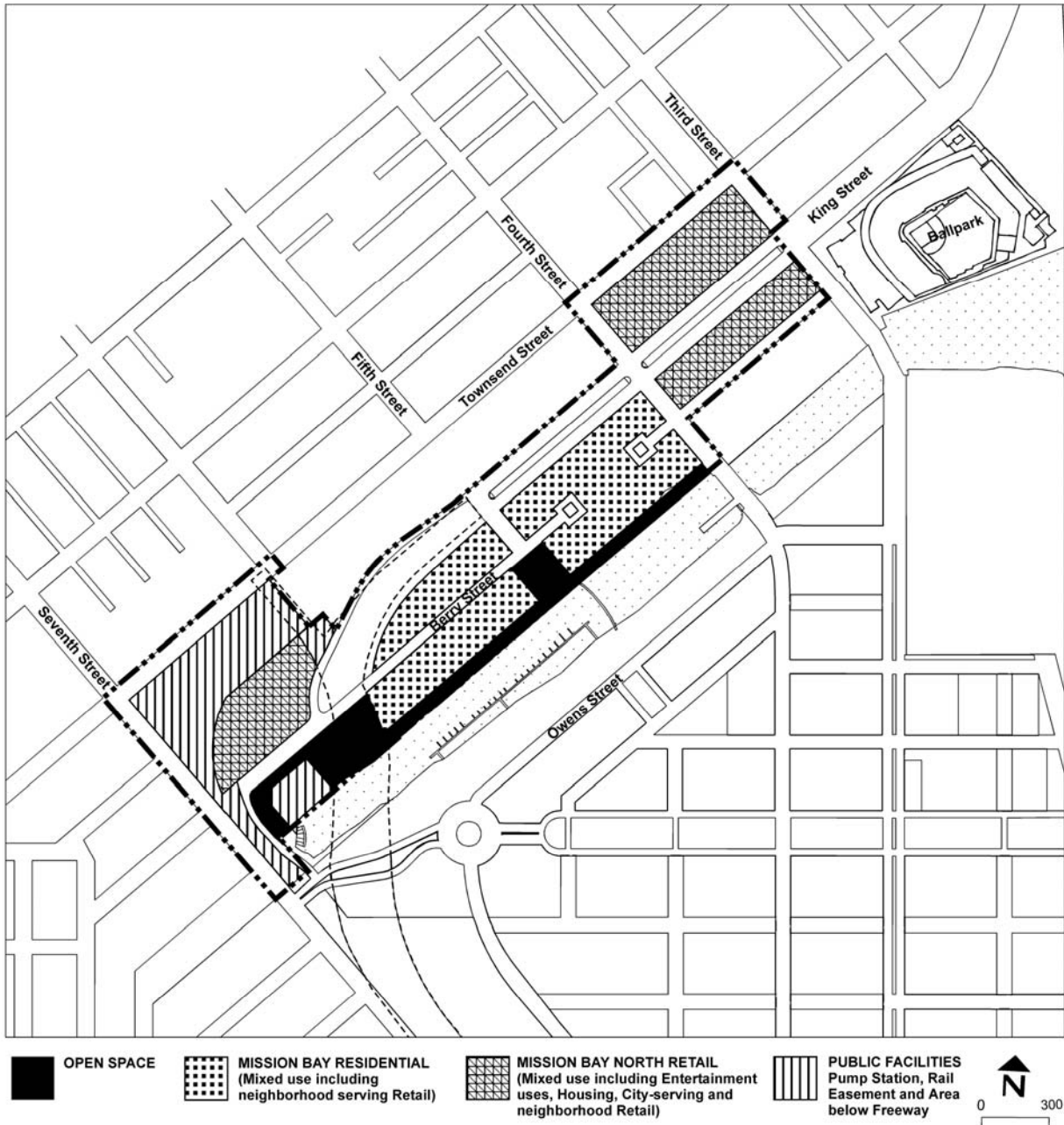

Note: Street alignments and open space configurations shown on the figure are not exact and are indicated for illustrative purposes.

ATTACHMENT 4

PROPOSED PUBLIC IMPROVEMENTS

Public roadways and other walkways, roadways, lanes and connections
Freeway improvements; such as bridge widenings and freeway ramp and related improvements
Median, curbs, gutters and sidewalks
Traffic signals, street signage and pavement striping
Street lighting
Landscaping (including street right-of-way landscaping)
Public open spaces, including plazas and parks
Functional and decorative facilities in parks and plazas such as fountains, bathrooms, benches, tables, trash receptacles, signage and landscaping
China Basin Channel and San Francisco Bay edge improvements and landscaping
Potable water distribution and fire suppression facilities (low pressure water and high pressure water)
Reclaimed and/or recycled water facilities
Combined and/or separated sanitary and storm sewer facilities (including pumping and treatment facilities)
Storm drains, pump station facilities, treatment facilities and flood control facilities
Natural gas, electric telephone and telecommunications facilities
Utilities and utility relocations
Suction inlets along China Basin Channel or the San Francisco Bay for fire protection
Pedestrian bridge across China Basin Channel
Structures for environmental investigation/testing/remediation in connection with roads, plazas, parks and other improvements
Water recirculation facilities
Rail relocations and facilities, signals, crossings and related improvements
Erosion control features
Improvements related to overland flows
MUNI light rail/bus/transit facilities and related improvements
Additional temporary, interim and/or permanent facilities and improvements related to the foregoing

ATTACHMENT 5

DEFINITIONS

Following are definitions for certain words and terms used in this Plan. All words used in the present tense shall include the future. All words in the plural number shall include the singular number and all words in the singular number shall include the plural number, unless the natural construction of the wording indicates otherwise. The word “shall” is mandatory and not directory.

Adult Entertainment. An amusement and entertainment use which includes the following: adult bookstore, as defined by Section 791 of the San Francisco Police Code; adult theater, as defined by Section 791 of the Police Code; and encounter studio, as defined by Section 1072.1 of the Police Code, as in effect as of the date of adoption of this Plan.

Amusement Enterprise. An amusement and entertainment use which provides eleven or more amusement game devices such as video games, pinball machines or other such similar mechanical and electronic amusement devices, in a quantity which exceeds that specified in Section 1036.31 of the San Francisco Police Code, as in effect as of the date of adoption of this Plan as accessory uses.

Animal Services. An animal care use which provides medical care and accessory boarding services for animals, not including a commercial kennel.

Arts Activities and Spaces. Arts activities shall include performance, exhibition (except exhibition of films), rehearsal, production, post-production and schools of any of the following: dance, music, dramatic art, film, video, graphic art, painting, drawing, sculpture, small-scale glass works, ceramics, textiles, woodworking, photography, custom-made jewelry or apparel, and other visual, performance and sound arts and crafts. It shall include commercial arts and art-related business service uses including, but not limited to, recording and editing services; small-scale film and video developing and printing; titling; video and film libraries; special effects production; fashion and photo stylists; production, sale and rental of theatrical wardrobes; and studio property production and rental companies. Art spaces shall include studios, workshops, galleries, museums, archives, and other similar spaces customarily used principally for arts activities, exclusive of Theaters, dance halls, and any other establishment where liquor is customarily served during performances.

Automobile Rental. A retail use which provides vehicle rentals whether conducted within a building or on an open lot.

Bar. A principal retail use not located in a Restaurant which provides on-site alcoholic beverage sales for drinking on the premises, including bars serving beer, wine and/or liquor to the customer where no person under 21 years of age is admitted (with Alcoholic Beverage Control “ABC” licenses 42, 48 or 61) and drinking establishments serving liquor (with ABC

licenses 47 or 49) in conjunction with other uses which admit minors, such as theaters and other entertainment.

Building. Any structure having a roof supported by columns or walls, and intended for permanent occupancy.

Building Code. The City's Building Code, Electric Code, Mechanical Code and Plumbing Code and any construction requirements in the Housing Code and the Fire Code of the City (including the Port).

Building Permit. A permit issued by the Central Permit Bureau of the City, which will allow the commencement of construction.

Business or Professional Service. An office use which provides to the general public, general business or professional services, including but not limited to, accounting, architectural, clerical, consulting, insurance, legal, management, real estate brokerage and travel services. It also includes business offices of building, electrical, furnace, painting, pest control, plumbing or roofing contractors, if no storage of equipment or items for wholesale use are located on-site. It may also include incidental accessory storage of office supplies and samples. Loading and unloading of all vehicles shall be located entirely within the building containing the use. It may provide services to the business community, provided that it also provides services to the general public. This use does not include research service of an industrial or scientific nature in a commercial or medical laboratory, other than routine medical testing and analysis by a health-care professional or hospital.

Catering Establishment. A home and business service, which involves the preparation and delivery of goods, such as the following items: food, beverages, balloons, flowers, plants, party decorations and favors, cigarettes and candy.

City Agency/Agencies. Includes all City departments, agencies, boards, commission and bureaus with subdivision or other permit, entitlement, or approval authority or jurisdiction over development within the Plan Area, or any portion thereof, including, without limitation, the Port Commission (the "Port"), the City Administrator, the Public Works Department, the Public Utilities Commission, the Planning Commission, the Public Transportation Commission, the Parking and Traffic Commission, the Building Inspection Commission, the Public Health Commission, the Fire Commission, and the Police Commission, together with any successor City Agency, department or officer designated by or pursuant to law.

City Regulations. Includes (i) those City land use codes, including those of its Port Commission (including, without limitation, the Planning and Subdivision Codes, the City General Plan and Waterfront Land Use Plan), (ii) those ordinances, rules, regulations and official policies adopted thereunder and (iii) all those ordinances, rules, regulations, official policies and plans governing zoning, subdivisions and subdivision design, land use, rate of development, density, building size, public improvements and dedications, construction standards, new construction and use, design standards, permit restrictions, development fees or exactions, terms and conditions of occupancy, or environmental guidelines or review, including

those relating to hazardous substances, pertaining to the Plan Area, as adopted and amended by the City from time to time.

Developable Land Area. All areas within a lot including without limitation, private open space, private lanes, and private sidewalks; but excluding public streets and rights-of-way, and public open space.

Dwelling Unit. A room or suite of two or more rooms that is designed for residential occupancy for 32 consecutive days or more, with or without shared living spaces, such as kitchens, dining facilities or bathrooms.

Existing City Regulations. Those City Regulations in effect as of the date of adoption of this Plan.

Family Child Care Facility. A use in a residential unit, which provides less than 24-hour care for up to 12 children by licensed personnel and which meets the requirements of the State of California and other authorities.

Floor Area Ratio. The ratio of the Gross Floor Area of buildings to Developable Land Area, calculated as described in Section 304.5 for Mission Bay North Retail areas. In cases in which portions of the Gross Floor Area of a building project horizontally beyond the lot lines, all such projecting Gross Floor Area shall also be included in determining the floor area ratio. If the height per story of a building, when all the stories are added together, exceeds an average of 18 feet, then additional Gross Floor Area shall be counted in determining the floor area ratio of the building, equal to the average Gross Floor Area of one additional story for each 18 feet or fraction thereof by which the total building height exceeds the number of stories times 18 feet; except that such additional Gross Floor Area shall not be counted in the case of Live/Work Units or a church, Theater or other place of public assembly.

Gross Floor Area. The sum of the gross areas of the several floors of a building or buildings, measured from the exterior faces of exterior walls or from the centerlines of walls separating two buildings. Where columns are outside and separated from an exterior wall (curtain wall) which encloses the building space or are otherwise so arranged that the curtain wall is clearly separate from the structural members, the exterior face of the curtain wall shall be the line of measurement, and the area of the columns themselves at each floor shall also be counted.

(a) Except as specifically excluded in this definition, “gross floor area” shall include, although not be limited to, the following:

- (1) Basement and cellar space, including tenants’ storage areas and all other space except that used only for storage or services necessary to the operation or maintenance of the building itself;
- (2) Elevator shafts, stairwells, exit enclosures and smokeproof enclosures, at each floor;

- (3) Floor space in penthouses except as specifically excluded in this definition;
 - (4) Attic space (whether or not a floor has been laid) capable of being made into habitable space;
 - (5) Floor space in balconies or mezzanines in the interior of the building;
 - (6) Floor space in open or roofed porches, arcades or exterior balconies, if such porch, arcade or balcony is located above the ground floor or first floor of occupancy above basement or garage and is used as the primary access to the interior space it serves;
 - (7) Floor space in accessory buildings, except for floor spaces used for accessory off-street parking or loading spaces as described herein, and driveways and maneuvering areas incidental thereto; and
 - (8) Any other floor space not specifically excluded in this definition.
- (b) “Gross floor area” shall not include the following:
- (1) Basement and cellar space used only for storage or services necessary to the operation or maintenance of the building itself;
 - (2) Attic space not capable of being made into habitable space;
 - (3) Elevator or stair penthouses, accessory water tanks or cooling towers, and other mechanical equipment, appurtenances and areas necessary to the operation or maintenance of the building itself, if located at the top of the building or separated therefrom only by other space not included in the gross floor area;
 - (4) Mechanical equipment, appurtenances and areas, necessary to the operation or maintenance of the building itself if located at an intermediate story of the building and forming a complete floor level;
 - (5) Outside stairs to the first floor of occupancy at the face of the building which the stairs serve, or fire escapes;
 - (6) Floor space used for accessory off-street parking and loading spaces and driveways and maneuvering areas incidental thereto;
 - (7) Arcades, plazas, walkways, porches, breezeways, porticos and similar features (whether roofed or not), at or near street level, accessible to the general public and not substantially enclosed by exterior walls; and accessways to public transit lines, if open for use by the general public; all exclusive of areas

devoted to sales, service, display, and other activities other than movement of persons;

(8) Balconies, porches, roof decks, terraces, courts and similar features, except those used for primary access as described in Paragraph (a)(6) above, provided that:

(A) If more than 70 percent of the perimeter of such an area is enclosed, either by building walls (exclusive of a railing or parapet not more than three feet eight inches high) or by such walls and interior lot lines, and the clear space is less than 15 feet in either dimension, the area shall not be excluded from gross floor area unless it is fully open to the sky (except for roof eaves, cornices or belt courses which project not more than two feet from the face of the building wall).

(B) If more than 70 percent of the perimeter of such an area is enclosed, either by building walls (exclusive of a railing or parapet not more than three feet eight inches high), or by such walls and interior lot lines, and the clear space is 15 feet or more in both dimensions, (1) the area shall be excluded from gross floor area if it is fully open to the sky (except for roof eaves, cornices or belt courses which project no more than two feet from the face of the building wall), and (2) the area may have roofed areas along its perimeter which are also excluded from gross floor area if the minimum clear open space between any such roof and the opposite wall or roof (whichever is closer) is maintained at 15 feet (with the above exceptions) and the roofed area does not exceed 10 feet in depth; (3) in addition, when the clear open area exceeds 625 square feet, a canopy, gazebo, or similar roofed structure without walls may cover up to 10 percent of such open space without being counted as gross floor area.

(C) If, however, 70 percent or less of the perimeter of such an area is enclosed by building walls (exclusive of a railing or parapet not more than three feet eight inches high) or by such walls and interior lot lines, and the open side or sides face on a yard, street or court, the area may be roofed to the extent permitted by such codes in instances in which required windows are involved;

(9) On lower, nonresidential floors, elevator shafts and other life-support systems serving exclusively the residential uses on the upper floors of a building;

(10) One-third of that portion of a window bay conforming to the requirements of Section 136(d)(2) of the San Francisco Planning Code (in effect as of the date of adoption of this Plan) which extends beyond the plane formed

by the face of the facade on either side of the bay but not to exceed seven square feet per bay window as measured at each floor;

- (11) Ground floor area devoted to building or pedestrian circulation and building service;
- (12) Space devoted to personal services, Restaurants, and retail sales of goods intended to meet the convenience shopping and service needs of downtown workers and residents, not to exceed 5,000 occupied square feet per use and, in total, not to exceed 75 percent of the area of the ground floor of the building plus the ground level, on-site open space;
- (13) An interior space provided as an open space feature in accordance with the requirements herein;
- (14) Floor area devoted to child care facilities provided that:
 - (A) Allowable indoor space is no less than 3,000 square feet and no more than 6,000 square feet, and
 - (B) The facilities are made available rent free, and
 - (C) Adequate outdoor space is provided adjacent, or easily accessible, to the facility. Spaces such as atriums, rooftops or public parks may be used if they meet licensing requirements for child care facilities, and
 - (D) The space is used for child care for the life of the building as long as there is a demonstrated need. No change in use shall occur without a finding by the Redevelopment Agency that there is a lack of need for child care and that the space will be used for a facility described herein dealing with cultural, educational, recreational, religious, or social service facilities;
- (15) Floor area permanently devoted to cultural, educational, recreational, religious or social service facilities available to the general public at no cost or at a fee covering actual operating expenses, provided that such facilities are:
- (16)
 - (A) Owned and operated by a nonprofit corporation or institution, or
 - (B) Are made available rent-free for occupancy only by nonprofit corporations or institutions for such functions. Building area subject to this subsection shall be counted as occupied floor area, except as

provided herein, for the purpose of calculating the off-street parking and freight loading requirements;

(C) For the purpose of calculating the off-street parking and freight loading requirement for the project, building area subject to this subsection shall be counted as occupied floor area, except as provided herein.

Home Occupation. A work-related use in a Dwelling Unit intended for sole proprietor businesses.

Leasable Floor Area. The Floor Rentable Area, as defined and calculated in the 1996 Building Owners and Managers Association International publication “Standard Method for Measuring Floor Area in Office Buildings.”

Live/Work Unit. A building or portion of a building combining residential living space with an integrated work space principally used by one or more of the residents. Live/work units are subject to the same land use controls as Dwelling Units.

Local-Serving Business. A local-serving business provides goods and/or services which are needed by residents and workers in the immediately surrounding neighborhood to satisfy basic personal and household needs on a frequent and recurring basis, and which if not available would require trips outside of the neighborhood. Office Uses with a single structure shall not be considered “Local-Serving Businesses” if the cumulative total of Office Uses in such structure exceeds 25,000 square feet. Also referred to as “neighborhood-serving” business.

Local-Serving Child Care Facility. A local-serving institutional use, which provides less than 24-hour care for children by licensed personnel and which meets the requirements of the State of California and other authorities. Such use is local-serving in that it serves primarily residents and workers of the immediately surrounding neighborhood on a frequent and recurring basis, and which if not available would require trips outside of the neighborhood.

Nighttime Entertainment. An assembly and entertainment use that includes dance halls, discotheques, nightclubs, private clubs, and other similar evening-oriented entertainment activities, excluding Adult Entertainment, which require dance hall keeper police permits or place of entertainment police permits which are not limited to non-amplified live entertainment, including Restaurants and Bars which present such activities, but shall not include any arts activities or spaces as defined by this Plan, any Theater performance space which does not serve alcoholic beverages during performances, or any temporary uses permitted by this Plan.

Office Use. A space within a structure intended or primarily suitable for occupancy by persons or entities which perform for their own benefit or provide to others at that location, administrative services, design services, business and professional services, financial services or medical services.

Open Air Sales. A retail use involving open air sale of new and/or used merchandise, except vehicles, but including agricultural products, crafts, and/or art work.

Open Recreation. An area, not within a building, which is provided for the recreational uses of patrons of a commercial establishment.

Outdoor Activity Area. An area, not including primary circulation space or any public street, located outside of a building or in a courtyard which is provided for the use or convenience of patrons of a commercial establishment including, but not limited to, sitting, eating, drinking, dancing, and food-service activities.

Parking. A parking facility serving uses located on either parcels or blocks occupied by said facility or on other parcels or blocks.

Plan Documents. This Plan and its implementing documents including, without limitation, any owner participation agreements, the Mission Bay North Design for Development and the Mission Bay Subdivision Ordinance and regulations adopted thereunder.

Restaurant. A full service or self-service retail facility primarily for eating use which provides ready-to-eat food to customers for consumption on or off the premises, which may or may not provide seating, and which may include a Bar. Food may be cooked or otherwise prepared on the premises.

Retail Sales and Services. A commercial use which provides goods and/or services directly to the customer including Outdoor Activity Areas and Open Air Sales Areas. It may provide goods and/or services to the business community, provided that it also serves the general public.

Storage. A use which stores goods and materials used by households or businesses at other locations, but which does not include junk, waste, salvaged materials, automobiles, inflammable or highly combustible materials. A storage building for household or business goods may be operated on a self-serve basis.

Theater. An assembly and entertainment use other than Adult Entertainment, which displays motion pictures, slides, or closed-circuit television pictures, or is used as live theater performance space.

Walk-Up Facility. A structure designed for provision of pedestrian-oriented services, located on an exterior building wall, including window service, self-service operations, and automated bank teller machines (“ATMs”).

**REDEVELOPMENT PLAN
FOR THE
MISSION BAY SOUTH REDEVELOPMENT PROJECT**



**SAN FRANCISCO
REDEVELOPMENT AGENCY**

NOVEMBER 2, 1998

**REDEVELOPMENT PLAN for the
MISSION BAY SOUTH PROJECT AREA**

**Approved and Adopted by
the Board of Supervisors
of the City and County of San Francisco
Ordinance No. 335-98, November 2, 1998**

TABLE OF CONTENTS

| SECTION | PAGE |
|---|-------------|
| 100 INTRODUCTION..... | 1 |
| 101 Legal Foundation | 1 |
| 102 Relationship of Plan to Plan Documents | 2 |
| 103 Redevelopment Project Objectives | 2 |
| 104 Planning Objectives and Policies..... | 3 |
| 200 DESCRIPTION OF THE PLAN AREA..... | 8 |
| 300 USES PERMITTED IN THE PLAN AREA | 8 |
| 301 Redevelopment Land Use Map..... | 8 |
| 302 Designated Land Uses | 8 |
| 302.1 Mission Bay South Residential..... | 8 |
| 302.2 Hotel..... | 10 |
| 302.3 Commercial Industrial | 11 |
| 302.4 Commercial Industrial/Retail..... | 13 |
| 302.5 UCSF..... | 14 |
| 302.6 Mission Bay South Public Facility | 16 |
| 302.7 Mission Bay South Open Space..... | 16 |
| 303 Other Land Uses | 16 |
| 303.1 Public Rights-of-Way | 16 |
| 303.2 Other Public and Semi-Public Uses..... | 17 |
| 303.3 Temporary and Interim Uses | 17 |
| 303.4 Nonconforming Uses | 18 |
| 304 General Controls and Limitations..... | 18 |
| 304.1 Construction..... | 18 |
| 304.2 Rehabilitation and Retention of Properties..... | 19 |
| 304.3 Limitation on the Number of Buildings..... | 19 |
| 304.4 Number of Dwelling Units..... | 19 |
| 304.5 Limitation on Type, Size and Height of Buildings..... | 19 |
| 304.6 Open Space | 20 |
| 304.7 Utilities..... | 20 |
| 304.8 Nondiscrimination and Nonsegregation | 20 |
| 304.9 Fees and Exactions..... | 20 |
| 304.10 Fees and Exactions: Parcels X2, X3 and X4 | 24 |
| 304.11 Office Development Limitations | 24 |
| 305 Variations..... | 24 |

| | |
|--|-----------|
| 306 Design for Development | 25 |
| 400 PROPOSED REDEVELOPMENT ACTIONS..... | 25 |
| 401 General Redevelopment Actions | 25 |
| 402 Participation Opportunities; Extension of Preferences for Reentry Within Redeveloped Plan Area..... | 26 |
| 402.1 Opportunities for Owners and Business Tenants..... | 26 |
| 402.2 Rules for Participation Opportunities, Priorities and Preferences | 26 |
| 402.3 Owner Participation Agreements..... | 26 |
| 402.4 Conforming Owners..... | 27 |
| 402.5 Phasing with Development | 27 |
| 403 Cooperation with Public Bodies | 27 |
| 404 Property Acquisition | 28 |
| 404.1 Real Property | 28 |
| 404.2 Personal Property | 28 |
| 405 Property Management..... | 28 |
| 406 Relocation of Persons, Business Concerns and Others Displaced by the Project | 28 |
| 406.1 Assistance in Finding Other Locations..... | 28 |
| 406.2 Relocation Payments..... | 28 |
| 407 Demolition, Clearance, and Building and Site Preparation | 29 |
| 407.1 Demolition and Clearance | 29 |
| 407.2 Preparation of Building Sites | 29 |
| 408 Property Disposition and Development..... | 29 |
| 408.1 Real Property Disposition and Development..... | 29 |
| 408.2 Disposition and Development Documents..... | 30 |
| 408.3 Development by the Agency..... | 30 |
| 408.4 Development Plans | 31 |
| 408.5 Personal Property Disposition | 31 |
| 409 Rehabilitation, Conservation and Moving of Structures | 31 |
| 409.1 Rehabilitation and Conservation..... | 31 |
| 409.2 Moving of Structures | 31 |
| 410 Low-and Moderate-Income Housing..... | 32 |
| 410.1 Replacement Housing | 32 |
| 410.2 Affordable Housing Production..... | 32 |
| 410.3 Increased and Improved Housing Supply | 32 |
| 500 METHODS OF FINANCING THE PROJECT | 33 |
| 501 General Description of the Proposed Financing Method..... | 33 |
| 502 Tax Increment Funds | 33 |
| 503 Other Loans and Grants | 35 |

600 ACTIONS BY THE CITY AND COUNTY35

700 ADMINISTRATION AND ENFORCEMENT35

800 PROCEDURE FOR AMENDMENT.....36

900 SEVERABILITY36

1000 DURATION AND EFFECTIVENESS OF THIS PLAN36

ATTACHMENT 1 LAND USE PLAN AND LEGAL DESCRIPTION.....37

ATTACHMENT 2 PLAN AREA MAP.....39

ATTACHMENT 3 REDEVELOPMENT LAND USE MAP.....40

ATTACHMENT 3a ZONE MAP.....41

ATTACHMENT 4 PROPOSED PUBLIC IMPROVEMENTS.....42

ATTACHMENT 5 DEFINITIONS.....43

ATTACHMENT 6 PLANNING COMMISSION RESOLUTIONError! Bookmark not defined.

100 INTRODUCTION

All initially capitalized terms shall have the meaning set forth herein, including Section 304.9 and Attachment 5.

101 Legal Foundation

This is the Redevelopment Plan (the “Plan”) for the Mission Bay South Redevelopment Project in the City and County of San Francisco (the “City”), State of California, and consists of the Text, the Legal Description of the Plan Area (Attachment 1), the Plan Area Map (Attachment 2), the Redevelopment Land Use Map (Attachment 3), the Zone Map (Attachment 3A), Proposed Public Improvements (Attachment 4) and Definitions (Attachment 5). This Plan was prepared by the Redevelopment Agency of the City and County of San Francisco (the “Agency”) pursuant to the Community Redevelopment Law of the State of California (Health and Safety Code Section 33000 *et seq.*), the California Constitution and all applicable local laws and ordinances. The Plan is also referred to as the “Mission Bay South Redevelopment Plan.” The Mission Bay South Project Area covered by this Plan is hereinafter referred to as the Plan Area.

The proposed redevelopment of the Plan Area as described in this Plan is consistent with the Central Waterfront Plan, adopted by the Planning Commission of the City and County of San Francisco (the “Planning Commission”) on September 27, 1990, and other applicable elements of the General Plan for the City and County of San Francisco, in effect on the effective date of this Plan, and is in conformity with the eight Priority Policies of Section 101.1 of the City Planning Code in effect at the date of adoption of this Plan.

This Plan is based upon a Preliminary Plan formulated and adopted by the Planning Commission by **Motion No. 14483**, on October 23, 1997. It provides the Agency with the powers, duties, and obligations to implement and further the program generally formulated in this Plan for the redevelopment, rehabilitation, and revitalization of the Plan Area. This Plan sets forth the objectives and the basic land use controls within which specific redevelopment activities in the Plan Area will be pursued. It is consistent with provisions of the Community Redevelopment Law in effect at the date of adoption of this Plan.

This Plan and the other Plan Documents, including the Design for Development, shall supersede the San Francisco Planning Code in its entirety, except as otherwise provided herein.

Regardless of any future action by the City or the Agency, whether by ordinance, resolution, initiative or otherwise, the rules, regulations, and official policies applicable to and governing the overall design, construction, fees, use or other aspect of development of the Plan Area shall be (i) this Plan and the other applicable Plan Documents, (ii) to the extent not inconsistent therewith or not superseded by this Plan, the Existing City Regulations and (iii) any new or changed City Regulations permitted under this Plan.

102 Relationship of Plan to Plan Documents

This Plan is enacted to establish the powers, duties, and obligations to implement and further the program generally formulated in this Plan. All real property in the Plan Area is made subject to the controls and requirements of this Plan, and the other applicable Plan Documents.

In order to facilitate the implementation of this Plan, the City and the Agency have entered into the Mission Bay South Interagency Cooperation Agreement (“ICA”). The ICA is intended to provide the framework for cooperation among various City Agencies and the Agency in accordance with this Plan and the other applicable Plan Documents with respect to the review and approval of development authorizations in the Plan Area and, where appropriate, to facilitate cooperation of the City Agencies in issuance of those permits, approvals, agreements and entitlements at each applicable stage of development.

103 Redevelopment Project Objectives

The purposes of the Community Redevelopment Law, which will be attained through, and the major objectives of this Plan are:

- A. Eliminating blighting influences and correcting environmental deficiencies in the Plan Area, including, but not limited to, abnormally high vacancies, abandoned buildings, incompatible land uses, depreciated or stagnant property values, and inadequate or deteriorated public improvements, facilities and utilities.
- B. Retaining and promoting, within the City and County of San Francisco, academic and research activities associated with the University of California San Francisco (“UCSF”), which seeks to provide space for existing and new programs and consolidate academic and support units from many dispersed sites at a single major new site which can accommodate the 2,650,000 square foot program analyzed in the UCSF Long Range Development Plan.
- C. Assembling land into parcels suitable for modern, integrated development with improved pedestrian and vehicular circulation in the Plan Area.
- D. Replanning, redesigning and developing undeveloped and underdeveloped areas which are improperly utilized.
- E. Providing flexibility in the development of the Plan Area to respond readily and appropriately to market conditions.
- F. Providing opportunities for participation by owners in the redevelopment of their properties.
- G. Strengthening the community’s supply of housing by facilitating economically feasible, affordable housing through installation of needed site improvements and expansion and improvement of the housing supply by the

construction of approximately 3,090 very low-, low- and moderate-income and market-rate units, including approximately 1,100 units of very low-, low- and moderate-income housing.

H. Strengthening the economic base of the Plan Area and the community by strengthening retail and other commercial functions in the Plan Area through the addition of approximately 335,000 Leasable square feet of retail space, a 500-room hotel and associated uses and about 5,953,600 Leasable square feet of mixed office, research and development and light manufacturing uses.

I. Facilitating emerging commercial-industrial sectors including those expected to emerge or expand due to their proximity to the UCSF new site, such as research and development, bio-technical research, telecommunications, business service, multi-media services, and related light industrial, through improvement of transportation access to commercial and industrial areas, improvement of safety within the Plan Area, and the installation of needed site improvements to stimulate new commercial and industrial expansion, employment, and economic growth.

J. Facilitating public transit opportunities to and within the Plan Area to the extent feasible.

K. Providing land in an amount of approximately 41 acres for a variety of publicly accessible open spaces.

L. Achieving the objectives described above in the most expeditious manner feasible.

104 Planning Objectives and Policies

The Central Waterfront Plan of the San Francisco General Plan sets forth broad land use planning objectives and policies for the entire Central Waterfront, of which Mission Bay South is a part. In addition to the redevelopment objectives listed in Section 103, the following planning objectives and policies provide a more detailed treatment of the basic General Plan objectives and policies for the Plan Area, and will guide the uses permitted in the Plan Area, the construction of facilities therein, and other physical development of the Plan Area. Application of these objectives and policies is a concerted effort to recognize the positive attributes of the City, to enhance and conserve those attributes, and to improve the quality of the living environment based on human needs. This Plan implements the following to the extent feasible:

A. LAND USE

Objective 1 Create a vibrant urban community in Mission Bay South which incorporates a variety of uses including medical research, office, business services, retail, entertainment, hotel, light industrial, education, utility, housing, recreation and open space, and community facilities.

Policy 1 Consider land use compatibility in siting the various uses.

Policy 2 Integrate Mission Bay South land uses, scale and circulation systems with surrounding districts and San Francisco Bay.

Policy 3 Create a variety of retail and other visitor-serving uses that benefit residents, workers and visitors, including regional retail, entertainment, recreational, and hotel uses.

Policy 4 Where appropriate, encourage the siting of ground floor neighborhood-serving retail and personal service uses in locations convenient to serve Mission Bay South businesses, residents, visitors and working populations, and/or encourage the siting of other pedestrian-interest activities along pedestrian pathways, at major intersections and at transit stops.

Policy 5 Where appropriate, design building forms and ground floor uses that enliven and activate streets and open space and which provide visual interaction between building occupants and pedestrians (“eyes on the street”) for safety and security.

Objective 2 Assure that adequate community services and facilities are provided for Mission Bay South residents and working population.

Policy 1 Provide for general community services and recreational facilities at a scale appropriate to serve Mission Bay South.

Policy 2 Include adequate public improvements, utilities and amenities.

B. URBAN DESIGN

Objective 3 Emphasize in Mission Bay South the characteristic San Francisco development patterns, which give its neighborhoods image and means of orientation.

Policy 1 Provide pedestrian scale and interest in ground floor treatments of buildings through the use of treatments such as clear glass fenestration, cornice treatments and detailed facades.

Policy 2 Design in consideration of protecting major views of the Bay, the Bay Bridge and the Downtown skyline from Mission Bay South and, if feasible, the elevated I-280 freeway along Mission Bay South, using street view corridors, open space, the careful placement of building forms and building massing.

Policy 3 Create a visual and physical access to San Francisco Bay and the channel of China Basin.

Policy 4 Recognize that buildings, open spaces and view corridors, seen together, will create the character of Mission Bay South.

- Policy 5 Achieve high quality design for buildings and landscaping.
- Policy 6 Emphasize the importance of intersections by encouraging higher density uses, taller buildings (one to two stories or the tallest portion of buildings) and architectural variety on street corners.
- Policy 7 Avoid extreme contrasts in color, shape and other characteristics, which will cause new buildings to stand out in excess of their public importance.
- Policy 8 Promote building forms that enhance sun exposure on public open spaces.
- Objective 4 Create a building form for the Mission Bay South area such that the scale of new development relates to the adjacent waterfront and to adjacent buildings.
- Policy 1 Building heights should decrease as they approach the water's edge.
- Policy 2 Provide variety in building design within a block to break up the perception of bulk and to achieve a visually interesting streetscape.

C. NEIGHBORHOOD ENVIRONMENT

- Objective 5 Develop new residential neighborhoods in consideration of the character and quality of traditional San Francisco neighborhoods.
- Policy 1 Create a pattern of buildings built to the front property line so that building facades generally define streets and public places.
- Policy 2 As appropriate to the neighborhood, provide on-street parking in the manner typical throughout the City. Limit the amount of curb cut and garage door access to off-street parking in housing blocks.
- Policy 3 Whenever possible, orient housing entrances toward the street or walkway.
- Policy 4 Screen parking garages at-grade along streets with retail, housing, art elements or landscape treatments.
- Policy 5 Encourage social interaction by use of outdoor common areas for horizontal circulation in residential blocks, when feasible.
- Policy 6 Provide adequate active outdoor recreation spaces, including passive recreational spaces, and facilities for the area's residential population.
- Policy 7 Provide for building security through street orientation of housing, housing design and adequate street lighting.

Policy 8 Provide for pedestrian and open space security through visibility of public spaces and avoid obscured spaces with little sense of proprietorship.

Policy 9 Design buildings in consideration of noise and traffic in the area. Such design can include measures such as placing residential units above a podium of parking or commercial uses, installing double-glazed windows and using sound attenuation construction methods and materials along the traffic-facing walls, placing sleeping quarters away from noise sources, and installing varieties of trees that tolerate traffic impacts.

D. RECREATION AND OPEN SPACE

Objective 6 Provide a variety of open spaces adequate to serve the Mission Bay South community and to augment the City's open space network.

Policy 1 Create parks, open space and recreational facilities within a comfortable walking/wheelchair traveling distance to serve the needs of Mission Bay South residents, workers and visitors of all ages and that are accessible to everyone, including the physically disabled and the elderly.

Policy 2 Create an open space network which provides walking, jogging and bicycle paths between recreation and open space areas throughout Mission Bay South, and provide connections to City-wide pedestrian, bicycle and open space networks, where applicable.

Policy 3 Orient development and parks, public and private open space, and pedestrian areas to facilitate solar access and wind protection for public open space where feasible and consistent with the land uses and intensities contemplated by this Plan.

Policy 4 Enhance parks and open spaces by maintaining view corridors from such areas.

E. COMMERCE AND INDUSTRY

Objective 7 Maintain, enhance and diversify a sound and dynamic economic base for Mission Bay South and the City.

Policy 1 Encourage the siting of educational institutions, medical research and development, retail, multi-media/ telecommunications, recreational, entertainment and public and private utility uses at Mission Bay South in a manner compatible with adjacent uses.

Policy 2 Encourage complementary support services to Mission Bay South such as office, light industrial, business service and neighborhood-serving retail in order to add to the economic diversity of the area and the City.

Objective 8 Expand employment opportunities in Mission Bay South for San Francisco residents.

Policy 1 Promote the creation of jobs for a highly skilled and professional work force.

Policy 2 Promote efforts to attract, retain and expand employment improvement opportunities for unskilled and semi-skilled workers.

F. TRANSPORTATION

Objective 9 Establish a street system, which is consistent in function and design with the character and use of adjacent land and efficient traffic flow.

Policy 1 Design the Mission Bay South street system in consideration of the layout of surrounding City streets consistent with the Infrastructure Plan for Mission Bay South.

Policy 2 Design the Mission Bay South streets (curb to curb) to the minimum scale necessary to provide required movement, parking, transit, bicycle and access functions.

Policy 3 Establish a truck route system to facilitate truck movements within and through Mission Bay South.

Policy 4 Within a “Transit First” environment, provide parking facilities in consideration of the needs of residents, workers, visitors and their service providers.

Policy 5 Explore opportunities for shared use of parking facilities, both day and night.

Objective 10 Accommodate the expansion of transit services to, from, through and within Mission Bay South.

Policy 1 Work with transit providers to coordinate the siting of transit stops at locations serving high-density uses.

Policy 2 Encourage the siting of shelters, and retail and personal service uses at or near transit stops.

Objective 11 Provide for the safe and convenient use of the bicycle as a means of transportation and recreation.

Objective 12 Provide for convenient, safe, and pleasant pedestrian circulation.

Policy 1 Recognize the importance of the pedestrian environment in the street level design of buildings.

Policy 2 Where appropriate, provide for public pedestrian-dominated streets with limited vehicular access.

Policy 3 Ensure quality street level environments, including street furniture.

Policy 4 Expand and enhance pedestrian access to San Francisco Bay and to the channel of China Basin.

200 DESCRIPTION OF THE PLAN AREA

The boundaries of the Plan Area are described in the “Legal Description of the Plan Area,” attached as Attachment 1 and shown on the “Plan Area Map,” attached as Attachment 2.

300 USES PERMITTED IN THE PLAN AREA

301 Redevelopment Land Use Map

The “Redevelopment Land Use Map,” attached hereto as Attachment 3, illustrates the location of the Plan Area boundaries, major streets within the Plan Area and the proposed land uses to be permitted in the Plan Area.

302 Designated Land Uses

Land uses are permitted in the Plan Area as either principal or secondary uses as provided below. Principal uses shall be permitted in the Plan Area in the particular land use district as set forth in Sections 302.1 through 302.7 of this Plan, in accordance with the provisions of this Plan.

Secondary uses shall be permitted in a particular land use district as set forth in Sections 302.1, 302.3 and 302.4, provided that such use generally conforms with redevelopment objectives and planning and design controls established pursuant to this Plan and is determined by the Executive Director to make a positive contribution to the character of the Plan Area, based on a finding of consistency with the following criterion: the secondary use, at the size and intensity contemplated and at the proposed location, will provide a development that is necessary or desirable for, and compatible with, the neighborhood or the community.

302.1 Mission Bay South Residential

The Mission Bay South Residential land use district, shown on the Redevelopment Land Use Map (Attachment 3), consists of residential uses and compatible local-serving retail and other uses which can be in mixed use facilities.

A. The following principal uses are permitted in the Mission Bay South Residential district:

Dwelling Units

Retail Sales and Services:

- Local-Serving Business, excluding Bars, aerobics studios, and dry-cleaning facilities that conduct onsite dry-cleaning operations
- Restaurants
- Automobile Rental

Arts Activities and Spaces:

- Arts activities in ground floor commercial spaces and/or in Live/Work Units

Office Use:

- Local-Serving Business above the ground floor

Home and Business Services:

- Catering Establishment
- Household and business repair
- Interior decorating shop

Other Uses:

- Family Child Care Facility
- Home Occupation
- Live/Work Units
- Open Recreation
- Outdoor Activity Area
- Parking
- Automated Teller Machines (ATMs)
- Telecommunications antenna and equipment
- Installation of tower or antenna for reception of radio and television for benefit of building occupants

- B. The following secondary uses shall be permitted in the Mission Bay South Residential district if the criteria set forth in this Section 302 are met:

Institutions, including but not limited to:

- Local-Serving Child Care Facility
- Small residential care facility licensed by the State
- Small social service/philanthropic facility
- Small vocational/job training facility
- Church/religious institution

Retail Sales and Services:

- Aerobics studios

Animal Care:

- Animal Services in enclosed building

Office Use:

Local-Serving Business on the ground floor

Other Uses:

Walk-Up Facility, except ATMs

Commercial wireless transmitting, receiving or relay facility with these reports if required

302.2 Hotel

The Hotel land use district, shown on the Redevelopment Land Use Map (Attachment 3), consists of primarily hotel, retail sales, destination retail, assembly and entertainment with compatible other uses, excluding Theaters.

The following principal uses are permitted in the Hotel district:

Retail Sales and Services:

Tourist Hotel

All Retail Sales and Services, including Bars and aerobic studios and excluding dry-cleaning facilities that conduct onsite dry-cleaning operations

Restaurants

Automobile Rental

Art Activities and Spaces

Assembly and Entertainment:

Amusement Enterprise

Nighttime Entertainment

Recreation building

Institutions:

Local-Serving Child Care Facility

Home and business services:

Catering Establishment

Animal Care:

Animal Services in enclosed building

Other Uses:

Open Recreation

Outdoor Activity Area

Parking

Walk-Up Facility, including ATMs

Commercial wireless transmitting, receiving or relay facility with required EMR reports

Telecommunications antenna and equipment
Installation of tower or antenna for reception of radio and television for
benefit of building occupants

302.3 Commercial Industrial

The Commercial Industrial land use district, shown on the Redevelopment Land Use Map (Attachment 3), consists of Commercial Industrial uses, including Manufacturing, Office Use, Animal Care facilities, Wholesaling and Other Uses, as described below. This district also includes compatible local-serving retail and personal services (excluding Theaters), consisting of the balance of the uses discussed below.

A. The following principal uses are permitted in the Commercial Industrial district:

Manufacturing (including office space and administrative uses associated therewith):

- Light manufacturing uses involving assembly, packaging, repairing or processing of previously prepared materials
- Software development and multimedia
- Industrial or chemical research or testing laboratory
- Medical research and bio-technical research facility
- Experimental laboratory

Institutions:

- Vocational/job training facility

Retail Sales and Services:

- Local-Serving Business, including Bars and aerobics studios
- Automobile Rental

Arts Activities and Spaces

Office Use

Home and business services:

- Blueprinting shop
- Building, plumbing, electrical, printing, roofing, furnace, or pest-control contractor's office
- Carpenter shop, sheet metal fabrication
- Household and business repair shop
- Multi-media business services
- Newspaper publication, desktop publishing
- Printing shop
- Sign-painting shop

Animal Care:

Animal Services in enclosed building
Animal care facilities for animal housing, handling, treatment, transport
Commercial kennel

Wholesaling:

Storage of household or business goods in enclosed building
Wholesale Sales and Services in enclosed building
Wholesale storage warehouse
Cold storage plant

Automotive:

Automobile service station
Automobile wash

Other Uses:

Greenhouse or plant nursery
Open Recreation
Outdoor Activity Area
Parking
Walk-Up Facility, including ATMs
Commercial wireless transmitting, receiving or relay facility with required
EMR reports
Telecommunications antenna and equipment
Installation of tower or antenna for reception of radio and television for
benefit of building occupants

- B. The following secondary uses shall be permitted in the Commercial Industrial district if the criteria set forth in this Section 302 are met:

Institutions, including but not limited to the following:

Clinic for outpatient care
Local-Serving Child Care Facility
Post secondary school
Social service/philanthropic facility
Church/religious institution
Clubhouse
Lodge building
Meeting hall

Assembly and Entertainment:

Nighttime Entertainment
Recreation building

Other Uses:

Public structure or use of a nonindustrial character

302.4 Commercial Industrial/Retail

The Commercial Industrial/Retail land use district, shown on the Redevelopment Land Use Map (Attachment 3), consists of industrial, commercial and office uses, retail and compatible other uses, excluding theaters, which can be in mixed-use facilities. The definitions of “Commercial Industrial” and “Retail” are as provided in Section 302.3.

- A. The following principal uses are permitted in the Commercial Industrial/Retail district:

Manufacturing (including office space and administrative uses associated therewith):

- Light manufacturing uses involving assembly, packaging, repairing or processing of previously prepared materials
- Software development and multimedia
- Industrial or chemical research or testing laboratory
- Medical research and bio-technical research facility
- Experimental laboratory

Institutions:

- Vocational/job training facility

Retail Sales and Services:

- All Retail Sales and Services, including Bars and aerobic studios
- Restaurants
- Automobile Rental

Arts Activities and Spaces

Office Use

Home and business services:

- Blueprinting shop
- Building, plumbing, electrical, printing, roofing, furnace, or pest-control contractor’s office
- Carpenter shop, sheet metal fabrication
- Household and business repair shop
- Multi-media business services
- Newspaper publication, desktop publishing
- Printing shop
- Sign-painting shop

Animal Care:

- Animal Services in enclosed building
- Animal care facilities for animal housing, handling, treatment, transport
- Commercial kennel

Wholesaling:

- Storage of household or business goods in enclosed building
- Wholesale Sales and Services in enclosed building
- Wholesale storage warehouse
- Cold storage plant

Automotive:

- Automobile service station
- Automobile wash

Other Uses:

- Greenhouse or plant nursery
- Open Recreation
- Outdoor Activity Area
- Parking
- Walk-Up Facility, including ATMs
- Commercial wireless transmitting, receiving or relay facility with required EMR reports
- Telecommunications antenna and equipment
- Installation of tower or antenna for reception or radio and television for benefit of building occupants

- B. The following secondary uses shall be permitted in the Commercial Industrial/Retail district if the criteria set forth in this Section 302 are met:

Institutions, including but not limited to:

- Local-Serving Child Care Facility
- Social service/philanthropic facility
- Church/religious institution
- Clinic for outpatient care
- Post secondary school
- Clubhouse
- Lodge building
- Meeting hall

Assembly and Entertainment:

- Nighttime Entertainment
- Recreation building

Other Uses:

- Public structure or use of a nonindustrial character

302.5 UCSF

The UCSF land use district, shown on the Redevelopment Land Use Map (Attachment 3), consists of institutional and academic uses as outlined in the 1996 Long Range Development

Plan (“LRDP”). The land use district includes a proposed approximately 2.2-acre San Francisco Unified School District public school site. (Refer to Section 403 herein regarding cooperation between UCSF and the Agency.) The following indicates the type of uses, as defined in the UCSF LRDP, that will be developed by The Regents in the UCSF land use district, and which are generally consistent with the uses contemplated under this Plan:

Instruction:

- Auditoriums, classrooms, seminar rooms
- Teaching laboratories

Research:

- Medical and biomedical laboratory facilities
- Office-based or computer-based research facilities
- Cold rooms, glass wash, microscopy areas, and other instrument areas

Clinical:

- Community-serving clinic for outpatient care

Academic Support:

- Animal care facilities for animal housing, handling, treatment, transport
- Library and library facilities
- Multimedia business services
- Newspaper publication, desktop publishing

Academic/Campus Administration:

- Administrative offices and administrative service
- Academic offices and academic department/school facilities
- Non-academic offices such as police and personnel offices

Campus Community:

- Arts activities
- Local-serving business and professional service
- Local-serving child care facility
- Elementary school or secondary school
- Local-serving retail business or personal service establishments
- Social service/philanthropic facility
- Meeting hall
- Recreation building
- Open recreation/open space
- Public structure or use of a non-industrial character

Logistics:

- Automatic laundry
- Dry-cleaning establishment and hand-ironing establishment
- Hospital laundry plant
- Blueprinting shop

Building, plumbing, electrical, printing, roofing, or pest-control office
Carpenter shop, sheet metal fabrication
Printing shop
Sign-painting shop
Service yard
Storage building
Cold storage plant
Utility plant
Installation of tower or antenna for reception
Uses accessory to and supportive of the principal uses within a building

302.6 Mission Bay South Public Facility

The Mission Bay South Public Facility land use district, shown on the Redevelopment Land Use Map (Attachment 3), consists of land other than housing sites or open space owned by a governmental agency or other public or semi-public entity and in some form of public or semi-public use.

The following principal uses are permitted in the Mission Bay South Public Facility district:

Fire/Police station
Open lot or enclosed Storage
Railroad tracks and related facilities
Other public structure or use

302.7 Mission Bay South Open Space

The Mission Bay South Open Space land use district, shown on the Redevelopment Land Use Map (Attachment 3), consists of a comprehensive system of open spaces, including parks, plazas, and open space corridors. Only recreational uses and uses accessory to and supportive of recreational use are permitted in this district including, but not limited to, accessory parking, kiosks and pushcarts; except that a facility containing up to 13,637 Leasable square feet of retail uses on a development footprint not to exceed 7,500 gross square feet may be constructed on parcel P22 on Attachment 2.

303 Other Land Uses

303.1 Public Rights-of-Way

As illustrated on the Redevelopment Land Use Map (Attachment 3) the major public streets within the Plan Area include: Owens Street, Third Street, Terry Francois Boulevard, Channel Street, Sixteenth Street, and Mariposa Street. Up to five new east-west major streets will be created between Channel Street and Sixteenth Street. Alignments are not exact and are shown on the Redevelopment Land Use Map for illustrative purposes.

Fourth Street will be realigned and extended from the channel of Mission Creek to Mariposa Street; Owens Street will be extended from Sixteenth Street to Mariposa Street; and Channel Street will be extended from Fourth Street to Third Street. Other existing streets, alleys and easements may be abandoned, closed or modified as necessary for proper development of the Plan Area.

Any changes in the existing street layout within the Plan Area, and in the event that Agency funding is used, outside of the Plan Area, shall be in accordance with the objectives of this Plan.

The public rights-of-way may be used for railroad, vehicular and/or pedestrian traffic, as well as for public improvements, public and private utilities and activities typically found in public rights-of-way. Railroad rights-of-way are allowed in any land use district.

Railroad rights-of-way may be outside the street rights-of-way.

303.2 Other Public and Semi-Public Uses

In any area shown on the Redevelopment Land Use Map (Attachment 3), the Agency is authorized to permit the maintenance, establishment or enlargement of utility easements and boxes and equipment appurtenant thereto. Other permitted public uses are specified in Sections 302.6 and 302.7 of this Plan.

303.3 Temporary and Interim Uses

Pending the ultimate development of land consistent with the land use program described in Attachment 3, certain interim and temporary uses are authorized as follows:

- A. Temporary Uses: The following uses are authorized as of right pursuant to this Plan for a period not to exceed ninety (90) days:
 - Booth for charitable, patriotic or welfare purposes;
 - Exhibition, celebration, festival, circus or neighborhood carnival;
 - Open Air Sales of agriculturally produced seasonal decorations including, but not necessarily limited to, Christmas trees and Halloween pumpkins;
 - Convention staging;
 - Parking; and
 - Truck parking and loading.

- B. Interim Uses: Interim Uses of over ninety (90) days may be authorized for an initial time period to be determined by the Executive Director of the Agency not to exceed fifteen (15) years, upon a determination by the Executive Director that the authorized uses will not impede the orderly development of the Plan Area as contemplated in this Plan. Extensions of this approval period may be authorized by the Executive Director in increments of up to five (5) year periods, subject to the same determination as required for the initial period. Permissible interim uses are as follows:

Rental or sales office incidental to a new development, provided that it be located in the development or a temporary structure;
Structures and uses incidental to environmental cleanup and staging;
Temporary structures and uses incidental to the demolition or construction of a structure, building, infrastructure, group of buildings, or open space, including but not limited to construction staging of materials and equipment;
Storage;
Parking; and
Truck Parking.

- C. Interim Pacific Bell Ballpark Parking: Interim parking associated with the Pacific Bell (San Francisco Giants) Ballpark within the Plan Area which was previously approved by the City Zoning Administrator is permitted as a matter of right, pursuant to the terms and conditions of the Zoning Administrator letter. Extensions of the original approval shall be governed by Section 303.3(B).

303.4 Nonconforming Uses

The Agency shall provide for the reasonable continuance, modification and/or termination of nonconformities as provided in this Section 303.4 to promote compatibility of uses, eliminate blighting conditions and effectuate the purposes, goals, and objectives of this Plan. The Agency shall permit the continuation of existing, nonconforming uses and structures for (1) 15 years after the date of adoption of this plan; or (2) for such use in fully enclosed warehouse buildings east of Third Street for an initial period through February 27, 2001 with an additional period of at least 25 years after the expiration of this initial period. In either case, the Executive Director is authorized to grant extensions of time if he/she determines that the extension will not impede the orderly development of the Plan Area. No extension shall be for a period in excess of two years. Successive extensions, subject to the same limitations, may be granted upon new application.

The Executive Director may authorize additions, alterations, reconstruction, rehabilitation, or changes in use through uses or structures which do not conform to the provisions of this Plan, subject to the same determination as is provided above for extensions of the nonconforming use period.

304 General Controls and Limitations

All real property in the Plan Area is made subject to the controls and requirements of this Plan. No real property shall be developed or rehabilitated after the date of the adoption of this Plan, except in conformance with the provisions of this Plan and the other applicable Plan Documents.

304.1 Construction

All construction in the Plan Area shall comply with the provisions of Section 306 of this Plan, the applicable Plan Documents, and all applicable laws.

304.2 Rehabilitation and Retention of Properties

Any existing structure within the Plan Area approved by the Agency for retention and rehabilitation shall be repaired, altered, reconstructed or rehabilitated in such a manner that it will be safe and sound in all physical respects and be attractive in appearance and not detrimental to the surrounding uses.

304.3 Limitation on the Number of Buildings

The number of Buildings in the Plan Area shall not exceed 500.

304.4 Number of Dwelling Units

The number of Dwelling Units presently in the Plan Area is currently none, and shall be approximately 3,090 under this Plan.

304.5 Limitation on Type, Size and Height of Buildings

The type of buildings may be as permitted in the Building Code as in effect from time to time. Approximately 335,000 Leasable square feet of retail space, a 500-room hotel, including associated uses such as retail, banquet and conferencing facilities, approximately 5,953,600 Leasable square feet of mixed office, research and development and light manufacturing uses, with about 2,650,000 square feet of UCSF instructional, research and support uses are allowed in the Plan Area.

The 5,953,600 Leasable square feet is allocated to the Zones depicted on Attachment 3A as follows: 504,000 Zone B; 414,000 Zone C; 35,600 Zone D. The balance is permitted in Zone A and on other sites designated Commercial Industrial on Attachment 3. In addition to the 5,953,600 Leasable square feet of Commercial Industrial uses, up to 45,000 Leasable square feet of such Commercial Industrial uses are permitted in Zone B and 36,000 Leasable square feet in Zone C, respectively, in lieu of all or a portion of the retail allocations provided below for such zones; provided, however, that the total development programs for Zones B and C shall not exceed 549,000 and 450,000 Leasable square feet, respectively.

Of the 335,000 Leasable square feet, up to 105,700 Leasable square feet may be City-serving retail, allocated as follows: 20,700 on blocks 29, 30, 31, 32 and 36 in Zone A; 45,000 Zone B; 36,000 Zone C; 4,000 Zone D. The balance of the permitted retail use, 229,300 Leasable square feet, is allocated as follows: 50,000 entertainment/neighborhood-serving retail in the Hotel district, 159,300 neighborhood-serving retail in Zone A and sites designated Commercial or Mission Bay South Residential on Attachment 3 in the Plan Area, and 20,000 neighborhood-serving retail on Agency-sponsored affordable housing sites.

In addition to the maximum densities described above, the following uses are permitted: (a) a total of up to approximately 10,000 additional Leasable square feet of neighborhood-serving retail uses on Agency-sponsored affordable housing sites (bringing the total permitted allocation of neighborhood-serving retail on Agency-sponsored affordable housing sites to

30,000 Leasable square feet); and (b) an up to approximately 13,637 Leasable square foot retail facility on parcel P22 on Attachment 2.

The floor area ratio for Commercial Industrial and Commercial Industrial/Retail shall be a maximum of 2.9:1, averaged over the entire area of these two land use districts combined, except that the area in Zones B-D shall be excluded from the calculation. The floor area ratio for Zones B-D shall be a maximum of 2.9:1, calculated separately for each Zone. Maximum building height within the Plan Area is 160 feet.

304.6 Open Space

Open space to be provided in the Plan Area is the total of all public open spaces and shall be approximately 41 acres, including approximately 8 acres of publicly accessible open space that will be provided within the UCSF land use district.

304.7 Utilities

All utilities within the Plan Area, and in the event Agency funding is used, outside of the Plan Area, shall be placed underground whenever physically and economically feasible.

304.8 Nondiscrimination and Nonsegregation

There shall be no discrimination or segregation based upon race, color, creed, religion, sex, gender identity, sexual orientation, age, marital or domestic partner status, national origin or ancestry, or disability including HIV/AIDS status permitted in the sale, lease, sublease, transfer, use, occupancy, tenure or enjoyment of property in the Plan Area.

304.9 Fees and Exactions: All Plan Area Property Excepting X2, X3 and X4

The following provisions shall apply to all property in the Plan Area excepting the property designated X2, X3 and X4 on Attachment 2 and parcels utilized as affordable housing developed by Agency-sponsored entities.

- A. Definitions: For purposes of this Section 304.9 only, the definitions below shall apply.

Administrative Fee. Any fee charged by any City Agency or the Agency in effect at the time of submission for the processing of any application for Building Permits, subdivision maps, other City regulatory actions or approvals for a Major Phase or Project in the Plan Area that are generally applicable on a City-wide basis for similar land uses.

Art Requirement. The installation and maintenance of works of art costing an amount equal to 1 percent of the hard costs of initial construction (excluding therefrom the costs of Infrastructure and tenant improvements) of a Project for retail or commercial uses exceeding 25,000 gross square feet of floor area prior to the issuance of the first certificate of occupancy or such later time as may be determined by the Agency not to exceed one year thereafter; provided, however,

that where the works of art are proposed to be included within an Open Space Parcel, such installation may occur any time prior to completion of the improvements to the Open Space Parcel. Such works may include sculpture, bas-relief, murals, mosaics, decorative water features, fountains, tapestries or other artwork and shall be located in and permanently affixed to a Project, its grounds or an Open Space Parcel or the surrounding area.

Child Care Requirements. The requirements set forth in City Planning Code Section 314.

City-Wide. All privately-owned property within (1) the territorial limits of the City or (2) any designated use district or use classification of the City so long as (a) any such use district or use classification includes more than an insubstantial amount of affected private property other than affected private property within the Plan Area and the Mission Bay North Plan Area, (b) the use district or use classification includes all private property within the use district or use classification that receives the general or special benefits of, or causes the burdens that occasion the need for, the new City Regulation or Development Fees or Exactions, and (c) the cost of compliance with the new City Regulation or Development Fee or Exaction applicable to the same type of use in the Plan Area (or portion thereof) does not exceed the proportional benefits to, or the proportional burdens caused by private development of that type of use in, the Plan Area (or portion thereof).

Development Fees or Exactions. A monetary or other exaction including in-kind contributions, other than a tax or special assessment or Administrative Fee, which is charged by the Agency or any City Agency in connection with any permit, approval, agreement or entitlement for a Major Phase or Project or any requirement for the provision of land for a construction of public facilities or Infrastructure or any requirement to provide or contribute to any public amenity or services. Development Fee or Exaction does not include Building Codes in effect from time to time generally applicable on a City-wide basis to similar land uses.

Improvements. Buildings, structures, Infrastructure and other work of improvement to be constructed in or for the benefit of the Plan Area.

Infrastructure. Open space (including, among other items, park improvements and restrooms), streets, sewer and storm drainage systems, water systems, street improvements, traffic signal systems, dry utilities, and other Improvements any of which are to be constructed in or for the benefit of the Plan Area.

Major Phase. A development segment comprising one or more of the numbered parcels shown on Attachment 2 (or portions of parcels) included with a numbered parcel or a remaindered parcel if so approved by Agency pursuant to the design review and document approval procedure under an applicable owner participation agreement containing one or more Projects.

Open Space Parcel. Those parcels or portions thereof designated for use as parks, plazas, or other public open space in Attachment 3 of this Plan.

Project. An individual Building and the related Improvements anticipated to be constructed in connection therewith under this Plan.

School Facilities Impact Fee. The sum payable to the San Francisco Unified School District pursuant to Government Code Section 65995.

- B. Administrative Fees: Nothing in this Plan shall preclude or constrain the Agency or any City Agency from charging and collecting an Administrative Fee or any such fee which may be provided for in any owner participation agreement.
- C. Development Fees and Exactions:
- (i) Existing Development Fees or Exactions. Except as provided in the following provisions of this Section 304.9C, from and so long as this Plan is in effect, the following Development Fees or Exactions as same are in effect as of the date of adoption of this Plan, and only the following, are applicable to the Plan Area: (a) the School Facilities Impact Fee; (b) the Child Care Requirements; and (c) the Art Requirement.
- (ii) New or Increased Development Fees or Exactions. No increase in any Development Fee or Exaction and no new Development Fee or Exaction shall be applicable to the Plan Area for ten (10) years following the date of issuance to Owner of the first Building Permit for a Project in the South Plan Area and, thereafter, shall only be applicable if said new or increased Development Fee or Exaction is generally applicable on a City-Wide basis to similar land uses; provided, however, that any increase in the School Facilities Impact Fee authorized by any change in state law at any time after the approval of this Plan shall apply. Any new or increased Development Fee or Exaction which becomes effective more than ten (10) years following the date of issuance to Owner of the first Building Permit for a Project in the Plan Area shall be applicable to the Plan Area so long as such new or increased Development Fee or Exaction is (i) generally applicable on a City-Wide basis to similar land uses and (ii) not redundant as to the initial Project of a fee, dedication, program, requirement or facility described in the applicable Plan Documents related to (A) affordable housing or (B) open space.

Notwithstanding the foregoing, new or increased Development Fees or Exactions may be imposed in order to comply with changes in applicable federal or state law or regulations as further provided in Subsection 304.9C(iii); provided, however, that any such new or increased Development Fee or Exaction shall be applied to the Plan Area on a Project by Project basis in a manner which is proportional to the impacts caused by the development in the Plan Area; that is, any such Development Fee or Exaction shall be no more than the equitable share of the cost of funding reasonable compliance with the applicable federal or state

law or regulation taking into account the equitable amount allocable to the impacts caused by previous or existing development within the City. In no event shall any Project within the Plan Area be required to pay a new or increased Development Fee or Exaction in connection with compliance with any such federal or state law or regulation which is not applied on a City-Wide basis to similar land uses.

(iii) Protection of Public Health and Safety. Notwithstanding any provision of this Section 304.9C to the contrary, the Agency and any City Agency having jurisdiction, shall exercise its discretion under this Plan and the other applicable Plan Documents in a manner which is consistent with the public health, safety and welfare and shall retain, at all times, its and their respective authority to take any action that is necessary to protect the physical health and safety of the public including without limitation authority to condition or deny a permit, approval, agreement or other entitlement or to change or adopt any new City Regulation if required (a) to protect the physical health or safety of the residents in the Plan Area, the adjacent community or the public, or (b) to comply with applicable federal or state law or regulations including without limitation changes in Existing City Regulations reasonably calculated to achieve new, more restrictive federal or state attainment or other standards applicable to the City for water quality, air quality, hazardous materials or otherwise relating to the physical environment where such City Regulations are generally applicable and proportionally applied to similar land uses on a City-Wide basis but subject, in all events, to any rights to terminate any owner participation agreement between an owner and the Agency as set forth in the applicable Plan Documents. Except for emergency measures, any City Agency or the Agency, as the case may be, will meet and confer with the owner in advance of the adoption of such measures to the extent feasible, provided, however, that said City Agency and the Agency shall each retain the sole and final discretion with regard to the adoption of any new City Regulation in furtherance of the protection of the physical health and safety of the public as provided in this Subsection 304.9C(iii).

(iv) Nonconflicting Laws. In addition to the reservation set forth in Section 304.9C(iii), the City Agencies and the Agency reserve the right to impose any new City Regulations and any changes to the Existing City Regulations (except for the Planning Code sections superseded by this Plan) that do not conflict with the development allowed by this Plan and the other applicable Plan Documents. As used herein, “conflict” means any proposed new or changed City Regulations which preclude or materially increase the cost of performance of or compliance with any provision of this Plan or the applicable Plan Documents or do any of the following: alter the permitted uses of land; decrease the maximum building height of buildings; reduce the density or intensity of development permitted; delay development; limit or restrict the availability of Infrastructure; impose limits or controls on the timing, phasing or sequencing of development; or modify Development Fees or Exactions except as permitted by this Section 304.9C. Notwithstanding the foregoing, the City may apply its then

current standards for Infrastructure pursuant to then applicable City Regulations. Nothing in this Plan or the other applicable Plan Documents shall be deemed to limit any City Agency's or the Agency's ability to comply with the California Environmental Quality Act ("CEQA").

304.10 Fees and Exactions: Parcels X2, X3 and X4

The parcels designated X2, X3 and X4 (as shown on Attachment 2) shall be subject to all fees and exactions under the City Planning Code in effect from time to time, except as otherwise provided pursuant to an owner participation agreement if the Agency determines that the public benefits under the owner participation agreement exceed those that would otherwise be obtained through imposition of the City Planning Code fees and exactions.

304.11 Office Development Limitations. By Resolution No. 14702, the Planning Commission adopted findings pursuant to Planning Code Section 321(b)(1) that the office development contemplated in this Plan in particular promotes the public welfare, convenience and necessity, and in so doing considered the criteria of Planning Code Section 321(b)(3)(A)-(G). The findings contained in Resolution No. 14702 are incorporated herein by reference and attached as Attachment 6 to this Plan. Because the office development contemplated by this Plan has been found to promote the public welfare, convenience and necessity, the determination required under Section 321(b), where applicable, shall be deemed to have been made for all specific office development projects undertaken pursuant to this Plan. No office development project contemplated by this Plan may be disapproved either (i) for inconsistency with Planning Code Sections 320-325 or (ii) in favor of another office development project that is located outside the Plan Area and subject to Planning Code Sections 320-325; provided, however, that (x) no office development project shall be approved that would cause the then applicable annual limitation contained in Planning Code Section 321 to be exceeded, and (y) the Planning Commission shall consider the design of the particular office development project to confirm that it is consistent with the Commission's findings contained in Resolution No. 14702. Upon such determination, the Planning Commission shall issue a project authorization for such project. The decision on the design of any particular office development project reviewed pursuant to this Section 304.11 shall be binding on the Agency.

305 Variations

The Agency may modify the land use controls in this Plan where, owing to unusual and special conditions, enforcement would result in undue hardships or would constitute an unreasonable limitation beyond the intent and purposes of these provisions. Upon written request for variation from the Plan's land use provisions from the owner of the property, which states fully the grounds of the application and the facts pertaining thereto, and upon its own further investigation, the Agency may, in its sole discretion, grant such variation from the requirements and limitations of this Plan. The Agency shall find and determine that the variation results in substantial compliance with the intent and purpose of this Plan, provided that in no instance will any variation be granted that will change the land uses of this Plan.

306 Design for Development

Within the limits, restrictions and controls established in this Plan, the Agency is authorized to establish height limits of buildings, land coverage, density, setback requirements, design and sign criteria, traffic circulation and access standards, and other development and design controls necessary for proper development of both private and public areas within the Plan Area, as set forth in the Design for Development.

400 PROPOSED REDEVELOPMENT ACTIONS

401 General Redevelopment Actions

The Agency proposes to achieve the objectives of Sections 103 and 104 and effectuate the policies of Section 104 of this Plan by:

- A. The acquisition of real property;
- B. The demolition or removal of certain buildings and improvements and the relocation of rail lines;
- C. The provision for participation in redevelopment by owners presently located in the Plan Area and the extension of preferences to business occupants and other tenants desiring to remain or relocate within the redeveloped Plan Area;
- D. The management of any property acquired by and under the ownership or control of the Agency;
- E. The provision of relocation assistance to eligible occupants displaced from property in the Plan Area;
- F. The installation, construction or reconstruction of streets, utilities, parks, other open spaces, and other public improvements;
- G. The disposition of property for uses in accordance with this Plan;
- H. The redevelopment of land by private enterprise or public agencies for uses in accordance with this Plan and to promote economic development of the area;
- I. The rehabilitation of structures and improvements by present owners, their successors and the Agency;
- J. The assembly of adequate sites for the development and construction of residential, commercial or industrial facilities; and
- K. Provision for very low-, low- and moderate-income housing.

To accomplish the above activities in the implementation and furtherance of this Plan, the Agency is authorized to use all the powers provided in this Plan and all the powers now or hereafter permitted by law.

402 Participation Opportunities; Extension of Preferences for Reentry Within Redeveloped Plan Area

402.1 Opportunities for Owners and Business Tenants

In accordance with this Plan and the rules for participation by owners and the extension of preferences to business tenants adopted by the Agency pursuant to this Plan and the Community Redevelopment Law, persons who are owners of real property in the Plan Area shall be given a reasonable opportunity to participate in redevelopment by: (1) retaining all or a portion of their properties and developing or improving such property for use in accordance with this Plan; (2) acquiring adjacent or other properties within the Plan Area and developing or improving such property for use in accordance with this Plan; or (3) selling their properties to the Agency and purchasing other properties in the Plan Area.

The Agency shall extend reasonable preferences to persons who are engaged in business in the Plan Area to participate in the redevelopment of the Plan Area, or to reenter into business within the redeveloped Plan Area, if they otherwise meet the requirements of this Plan.

402.2 Rules for Participation Opportunities, Priorities and Preferences

In order to provide opportunities to owners to participate in the redevelopment of the Plan Area and to extend reasonable preferences to businesses to reenter into business within the redeveloped Plan Area, the Agency has promulgated rules for participation by owners and the extension of preferences to business tenants for reentry within the redeveloped Plan Area.

402.3 Owner Participation Agreements

The Agency shall require as a condition to participation in redevelopment that each participant enter into a binding agreement with the Agency by which the participant agrees to rehabilitate, develop, use and maintain the property in conformance with this Plan and to be subject to its provisions.

Whether or not a participant enters into an owner participation agreement with the Agency, all other provisions of this Plan are applicable to all public and private property in the Plan Area.

In the event that a participant fails or refuses to rehabilitate, develop and use and maintain its real property pursuant to this Plan and the owner participation agreement, the real property or any interest therein may be acquired by the Agency and sold or leased for rehabilitation or development in accordance with this Plan.

402.4 Conforming Owners

Subject to any owner participation agreement provisions, the Agency may determine in its sole and absolute discretion, that certain real property within the Plan Area meets the requirements of this Plan, and the owner of such property will be permitted to remain as a conforming owner without an owner participation agreement with the Agency, provided such owner continues to operate, use and maintain the real property within the requirements of this Plan. However, a conforming owner shall be required by the Agency to enter into an owner participation agreement with the Agency in the event that such owner desires to: (a) construct any additional improvements or substantially alter or modify existing structures on any of the real property described above as conforming; or (b) acquire additional contiguous property within the Plan Area.

402.5 Phasing with Development

Subject to the terms of owner participation agreements, owners shall be required to provide for infrastructure, affordable housing and open space in conjunction with development of improvements in the Plan Area.

403 Cooperation with Public Bodies

The Agency is authorized to financially (and otherwise) assist any public entity in the cost of public land, buildings, facilities, structures or other improvements (within or without the Plan Area) which land, buildings, facilities, structures or other improvements are or would be of benefit to the Plan Area, in accordance with the ICA.

The Regents of the University of California will work cooperatively with the Agency regarding land use and planning issues in that portion of the Plan Area to be used by the University for educational purposes. This cooperative effort will assure that the mutual interests of UCSF and the Agency are addressed. However, because the University is exempt under Article 9, Section 9 of the State Constitution from local planning, zoning and redevelopment regulations when using its property in furtherance of its educational purposes, the portion of the Plan Area to be used by UCSF for educational purposes would not be subject to the actions of the Agency to implement this Plan. That portion of the Plan Area within the UCSF land use district to be developed either as a site for the San Francisco Unified School District or as public open space and the dedicated public streets (i.e., 4th Street) would be subject to the jurisdiction of the Agency.

The Regents would develop the UCSF site in accordance with the uses and total gross square footage described in UCSF's 1996 Long Range Development Plan ("LRDP"), as it may be amended from time to time. The LRDP has been subjected to environmental analysis pursuant to the California Environmental Quality Act ("CEQA"), and a Final Environmental Impact Report has been certified by the Regents. As each UCSF development project within the Plan Area is proposed, the Regents will determine whether additional environmental review will be necessary. To the extent provided in CEQA, the CEQA Guidelines and the UC CEQA Handbook, the City, the Agency and the public would have an opportunity to comment on any environmental documentation prepared by the Regents for individual development projects.

404 Property Acquisition

404.1 Real Property

The Agency may acquire real property located in the Plan Area by any means authorized by law.

It is in the public interest and necessary in order to eliminate the conditions requiring redevelopment and in order to implement this Plan for the power of eminent domain to be employed by the Agency to acquire real property in the Plan Area which cannot be acquired by gift, devise, exchange, purchase or any other lawful method, except that the Agency is not authorized to employ the power of eminent domain to acquire property on which any persons legally reside. Eminent domain proceedings, if used, must be commenced within twelve (12) years from the date the ordinance adopting this Plan becomes effective.

The Agency is authorized to acquire structures without acquiring the land upon which those structures are located. The Agency is authorized to acquire either the entire fee or any other interest in real property less than a fee.

404.2 Personal Property

Where necessary to implement this Plan, the Agency is authorized to acquire personal property in the Plan Area by any lawful means, including eminent domain.

405 Property Management

During such time as property, if any, in the Plan Area is owned or leased by the Agency, such property shall be under the management and control of the Agency. Such property may be rented or leased by the Agency, and such rental or lease shall be pursuant to such policies as the Agency may adopt.

406 Relocation of Persons, Business Concerns and Others Displaced by the Project

406.1 Assistance in Finding Other Locations

The Agency shall assist or cause to be assisted all eligible persons (including individuals and families), business concerns and others displaced from the Plan Area pursuant to this Plan in finding other locations and facilities, as may be required by law. In order to implement this Plan with a minimum of hardship to eligible persons, business concerns and others, if any, displaced by implementation of this Plan, the Agency shall assist such persons, business concerns and others in finding new locations in accordance with all applicable relocation statutes and regulations (Section 33410 et seq. of the Community Redevelopment Law).

406.2 Relocation Payments

The Agency shall make or cause to be made relocation payments to persons (including individuals and families), business concerns and others displaced by implementation of this Plan as may be required by law. Such relocation payments shall be made pursuant to the California

Relocation Assistance Law (Government Code Section 7260 *et seq.*), Agency rules and regulations adopted pursuant thereto, and as may be applicable in the event that federal funding is used in the implementation of this Plan, in accordance with the Uniform Relocation Assistance and Real Property Acquisition Policies Act of 1970, as amended. The Agency may make such other payments as it determines to be appropriate and for which funds are available.

407 Demolition, Clearance, and Building and Site Preparation

407.1 Demolition and Clearance

The Agency is authorized to demolish and clear buildings, structures and other improvements from any real property in the Plan Area owned or leased by the Agency or other public entity as necessary to carry out the purposes of this Plan.

407.2 Preparation of Building Sites

The Agency is authorized to prepare, or cause to be prepared, as building sites, any real property in the Plan Area owned or leased by the Agency or other public entity. In connection therewith, the Agency may cause, provide for, or undertake the installation or construction of streets, utilities, parks, playgrounds and other public improvements necessary to carry out this Plan. The Agency is also authorized to construct foundations, platforms and other structural forms necessary for the provision or utilization of air rights sites for buildings to be used for residential, commercial, public and other uses provided in this Plan.

408 Property Disposition and Development

408.1 Real Property Disposition and Development

For the purposes of this Plan, the Agency is authorized to sell, lease, exchange, subdivide, transfer, assign, pledge, encumber by mortgage or deed of trust or otherwise dispose of any interest in real property. To the extent permitted by law, the Agency is authorized to dispose of or acquire real property by negotiated lease, sale or transfer without public bidding. Property containing buildings or structures rehabilitated by the Agency shall be offered for resale within one (1) year after completion of rehabilitation or an annual report concerning such property shall be published by the Agency as required by law.

Real property acquired by the Agency may be conveyed by the Agency without charge to the City and, where beneficial to the Plan Area, without charge to any public body. All real property acquired by the Agency in the Plan Area shall be sold or leased to public or private persons or entities for development for the uses permitted in this Plan, or may be developed by the Agency for public uses.

All purchasers or lessees of property acquired from the Agency shall be made obligated to use the property for the purposes designated in this Plan, to begin and complete development of the property within a period of time which the Agency fixes as reasonable and to comply with other conditions which the Agency deems necessary to carry out the purposes of this Plan.

408.2 Disposition and Development Documents

To provide adequate safeguards to ensure that the provisions of this Plan will be carried out and to prevent the recurrence of blight, all real property sold, leased or conveyed by the Agency, as well as all property subject to owner participation agreements, is subject to the provisions of this Plan.

The Agency shall reserve such powers and controls in the disposition and development documents as may be necessary to prevent transfer, retention or use of property for speculative purposes and to ensure that development is carried out pursuant to this Plan.

Leases, deeds, contracts, agreements and declarations of restrictions of the Agency may contain restrictions, covenants, covenants running with the land, rights of reverter, conditions subsequent, equitable servitudes or any other provisions necessary to carry out this Plan. Where appropriate, as determined by the Agency, such documents, or portions thereof, shall be recorded in the office of the County Recorder.

All property in the Plan Area is hereby subject to the restriction that there shall be no discrimination or segregation based upon race, color, creed, religion, sex, gender identity, sexual orientation, age, marital or domestic partner status, national origin or ancestry, or disability including HIV/AIDS status permitted in the sale, lease, sublease, transfer, use, occupancy, tenure or enjoyment of property in the Plan Area. All property sold, leased, conveyed or subject to a participation agreement shall be expressly subject by appropriate documents to the restriction that all deeds, leases or contracts for the sale, lease, sublease or other transfer of land in the Plan Area shall contain such nondiscrimination and nonsegregation clauses.

408.3 Development by the Agency

To the extent now or hereafter permitted by law, the Agency is authorized to pay for, develop or construct any publicly-owned building, facility, structure or other improvement either within or without the Plan Area, for itself or for any public body or entity, which buildings, facilities, structures or other improvements are or would be of benefit to the Plan Area. Specifically, the Agency may pay for, install or construct the buildings, facilities, structures and other improvements, and may acquire or pay for the land and site preparation required therefor.

In addition to the public improvements authorized under this Section 408 and the specific publicly-owned improvements, the Agency is authorized to install and construct, or to cause to be installed and constructed, within or without the Plan Area, for itself or for any public body or entity for the benefit of the Plan Area, public improvements and public utilities, including, but not limited to, those described in Attachment 4.

The Agency is authorized to install and construct or cause to be installed and constructed temporary public improvements necessary to carry out this Plan. Temporary public improvements may include, but are not limited to, parks, streets, and utilities. Temporary utilities may be installed above ground only with the written approval of the Agency.

The Agency may enter into contracts, leases and agreements with the City or other public body or entity pursuant to this Section 408.3, and the obligation of the Agency under such contract, lease or agreement shall constitute an indebtedness of the Agency which may be made payable out of the taxes levied in the Plan Area and allocated to the Agency under subdivision (b) Section 33670 of the Community Redevelopment Law, Section 502 of this Plan or out of any other available funds.

408.4 Development Plans

All private development plans shall be submitted to the Agency for approval and architectural review consistent with the Plan and the other applicable Plan Documents. Except for UCSF, all public development plans shall be in accordance with the Plan and any applicable Plan Documents.

408.5 Personal Property Disposition

For the purposes of this Plan, the Agency is authorized to lease, sell, exchange, transfer, assign, pledge, encumber or otherwise dispose of personal property which is acquired by the Agency.

409 Rehabilitation, Conservation and Moving of Structures

409.1 Rehabilitation and Conservation

The Agency is authorized to rehabilitate and conserve or to cause to be rehabilitated and conserved, any building or structure in the Plan Area owned by the Agency. The Agency is also authorized and directed to advise, encourage and assist in the rehabilitation and conservation of property in the Plan Area not owned by the Agency. The Agency is also authorized to acquire, restore, rehabilitate, move and conserve buildings of historic or architectural significance.

It shall be the purpose of this Plan to encourage the retention of existing businesses that are generally compatible with proposed developments in the Plan Area and in conformity with the uses permitted in this Plan, and to add to the economic viability of such businesses by programs that encourage voluntary participation in conservation and rehabilitation. The Agency is authorized to conduct a program of assistance and incentives to encourage owners of property within the Plan Area to upgrade and maintain their property in a manner consistent with the Plan and with other standards that may be established by the Agency for the Plan Area.

409.2 Moving of Structures

As necessary in carrying out this Plan, the Agency is authorized to move, or to cause to be moved, any structure or building which can be rehabilitated to a location within or outside the Plan Area.

410 Low-and Moderate-Income Housing

410.1 Replacement Housing

In accordance with Section 33334.5 of the Community Redevelopment Law, whenever dwelling units housing persons and families of low or moderate income are destroyed or removed from the low and moderate income housing market as part of implementation of this Plan, the Agency shall, within four (4) years of such destruction or removal, rehabilitate, develop or construct, or cause to be rehabilitated, developed or constructed, for rental or sale to persons and families of low or moderate income an equal number of replacement dwelling units at affordable rents within the Plan Area or within the territorial jurisdiction of the City in accordance with all of the provisions of Sections 33413 and 33413.5 of the Community Redevelopment Law.

410.2 Affordable Housing Production

In accordance with subdivision (b) of Section 33413 of the Community Redevelopment Law, at least 15 percent of all new or rehabilitated dwelling units developed within the Plan Area by public or private entities or persons other than the Agency, shall be available at affordable housing cost to persons and families of very low, low or moderate income. Not less than 40 percent of the dwelling units required to be available at affordable housing cost to persons and families of very low, low or moderate income shall be available at affordable housing cost to very low income households.

At least 30 percent of all new or rehabilitated dwelling units developed by the Agency shall be available at affordable housing cost to persons and families of very low, low or moderate income. Not less than 50 percent of these dwelling units shall be available at affordable housing cost to, and occupied by, very low income households.

410.3 Increased and Improved Housing Supply

Pursuant to Section 33334.2 of the Community Redevelopment Law, not less than twenty percent (20%) of all taxes which are allocated to the Agency pursuant to subdivision (b) of Section 33670 of the Community Redevelopment Law and Section 502 of this Plan shall be used by the Agency for the purposes of increasing, improving and preserving the City's supply of housing for persons and families of very low, low or moderate income unless certain findings are made as required by that section to lessen or exempt such requirement. In carrying out this purpose, the Agency may exercise any or all of its powers, including the following:

- A. Acquire land or building sites;
- B. Improve land or building sites with on-site or off-site improvements;
- C. Donate land to private or public persons or entities;
- D. Finance insurance premiums pursuant to Section 33136 of the Community Redevelopment Law;

- E. Construct buildings or structures;
- F. Provide subsidies to or for the benefit of persons or families of very low, low or moderate income;
- G. Develop plans, pay principal and interest on bonds, loans, advances or other indebtedness or pay financing or carrying charges;
- H. Preserve the availability of affordable housing units which are assisted or subsidized by public entities and which are threatened with conversion to market rates;
- I. Require the integration of affordable housing sites with sites developed for market rate housing;
- J. Assist the development of housing by developers.

The Agency may use the funds specified in this Section to meet, in whole or in part, the replacement housing provisions in Section 410.1 or the affordable housing production provisions in Section 410.2 above. These funds may be used inside the Plan Area, or outside the Plan Area only if findings of benefit to the Plan Area are made as required by said Section 33334.2 of the Community Redevelopment Law.

500 METHODS OF FINANCING THE PROJECT

501 General Description of the Proposed Financing Method

The Agency is authorized to finance the implementation of this Plan with financial assistance from the City, State of California, federal government, tax increment funds, interest income, Agency bonds, donations, loans from private financial institutions, assessments, the lease or sale of Agency-owned property or any other available source, public or private.

The Agency is also authorized to obtain advances, borrow funds and create indebtedness in carrying out this Plan. The principal and interest on such advances, funds and indebtedness may be paid from tax increments or any other funds available to the Agency.

The City or any other public agency may expend money to assist the Agency in carrying out this Plan. As available, gas tax funds from the state and county may be used for street improvements and public transit facilities.

502 Tax Increment Funds

All taxes levied upon taxable property within the Plan Area each year, by or for the benefit of the State of California, the City, any district or any other public corporation (hereinafter sometimes called “taxing agencies”) after the effective date of the ordinance approving this Plan, shall be divided as follows:

- A. That portion of the taxes which would be produced by the rate upon which the tax is levied each year by or for each of said taxing agencies upon the total sum of the assessed value of the taxable property in the Plan Area as shown upon the assessment roll used in connection with the taxation of such property by such taxing agencies, last equalized prior to the effective date of such ordinance, shall be allocated to and when collected shall be paid into the funds of the respective taxing agencies as taxes by or for said taxing agencies on all other property are paid (for the purpose of allocating taxes levied by or for any taxing agency or agencies which does not include the territory of the Plan Area on the effective date of such ordinance but to which such territory is annexed or otherwise included after such effective date, the assessment roll of the County of San Francisco last equalized on the effective date of said ordinance shall be used in determining the assessed valuation of the taxable property in the Plan Area on said effective date).

- B. Except as provided in subdivision (e) of Section 33670 or in Section 33492.15 of the Community Redevelopment Law, that portion of said levied taxes each year in excess of such amount shall be allocated to and, when collected, shall be paid into a special fund of the Agency to pay the principal of and interest on loans, monies advanced to or indebtedness (whether funded, refunded, assumed or otherwise) incurred by the Agency to finance or refinance, in whole or in part, the implementation of this Plan. Unless and until the total assessed valuation of the taxable property in the Plan Area exceeds the total assessed value of taxable property in the Plan Area as shown by the last equalized assessment roll referred to in subdivision A hereof, all of the taxes levied and collected upon the taxable property in the Plan Area shall be paid into the funds of the respective taxing agencies. When said loans, advances indebtedness, if any, and interest thereon, have been paid, all monies thereafter received from taxes upon the taxable property in the Plan Area shall be paid into the funds of the respective taxing agencies as taxes on all other property are paid.

The portion of taxes mentioned in 502B above are hereby irrevocably pledged for the payment of the principal of and interest on the advance of monies, or making of loans or the incurring of any indebtedness (whether funded, refunded, assumed or otherwise) by the Agency to finance or refinance the implementation of this Plan in whole or in part, including but not limited to direct and indirect expenses. The Agency is authorized to make such pledges as to specific advances, loans and indebtedness as appropriate in carrying out this Plan.

The Agency is authorized to issue bonds from time to time, if it deems appropriate to do so, in order to finance all or any part of the implementation of this Plan. Neither the members of the Agency nor any persons executing the bonds are liable personally on the bonds by reason of their issuance.

The amount of bonded indebtedness of the Agency to be repaid from the allocation of taxes to the Agency pursuant to Section 33670 of the Community Redevelopment Law, which

can be outstanding at one time, shall not exceed \$450,000,000, except by amendment of this Plan.

The bonds and other obligations of the Agency are not a debt of the City or the State, nor are any of its political subdivisions liable for them, nor in any event shall the bonds or obligations be payable out of any funds or properties other than those of the Agency, and such bonds and other obligations shall so state on their face. The bonds do not constitute indebtedness within the meaning of any constitutional or statutory debt limitation or restriction.

The Agency shall not establish or incur loans, advances or indebtedness to finance in whole or in part the Project beyond twenty (20) years from the effective date of the ordinance adopting this Plan unless amended following applicable provisions of the Community Redevelopment Law, except that the Agency may incur loans, advances or indebtedness beyond twenty (20) years from the effective date of the ordinance adopting this Plan to be paid from the Low and Moderate Income Housing Fund as defined by the Community Redevelopment Law or to meet the Agency's replacement housing or inclusionary housing requirements as set forth in Sections 33413 and 33413.5 of the Community Redevelopment Law. This limit shall not prevent the Agency from refinancing, refunding, or restructuring indebtedness after the time limit if the indebtedness is not increased and the time during which the indebtedness is to be repaid is not extended beyond the time limit to repay indebtedness required by Section 33333.2 of the Community Redevelopment Law.

The Agency shall not pay indebtedness or receive property taxes pursuant to Section 33670 from the Plan Area after forty-five (45) years from the effective date of the ordinance adopting this Plan.

503 Other Loans and Grants

Any other loans, grants, guarantees or financial assistance from the United States government, the State of California or any other public or private source will be used if available.

600 ACTIONS BY THE CITY AND COUNTY

The City shall aid and cooperate with the Agency in carrying out this Plan and shall take all actions necessary to ensure the continued fulfillment of the purposes of this Plan and the other applicable Plan Documents, including preventing the recurrence or spread of conditions causing blight in the Plan Area, pursuant to the ICA.

700 ADMINISTRATION AND ENFORCEMENT

Except as otherwise specified in Section 600 above, the administration and enforcement of this Plan, including the preparation and execution of any documents implementing this Plan, shall be performed by the Agency.

The provisions of this Plan or other documents entered into pursuant to this Plan may also be enforced by legal action instituted by the Agency to seek appropriate remedy, except as may be limited by owner participation agreements. Such remedies may include, but are not limited to, specific performance, damages, reentry, injunctions or any other remedies appropriate to the purposes of this Plan. In addition, any recorded provisions, which are expressly for the benefit of owners of property in the Plan Area, may be enforced by such owners.

800 PROCEDURE FOR AMENDMENT

This Plan may be amended by means of the procedure established in Sections 33450-33458 of the Community Redevelopment Law or by any other procedure hereafter established by law.

900 SEVERABILITY

If any provision, section, subsection, subdivision, sentence, clause or phrase of the Plan is for any reason held to be invalid or unconstitutional, such decision shall not affect the validity of the remaining portion or portions of the Plan.

1000 DURATION AND EFFECTIVENESS OF THIS PLAN

The Provisions of this Plan shall be effective for thirty (30) years from the date of adoption of this Plan by the Board of Supervisors, except that the nondiscrimination and nonsegregation provisions shall run in perpetuity. After this time limit on the duration and effectiveness of the plan, the Agency shall have no authority to act pursuant to this Plan except to pay previously incurred indebtedness and to enforce existing covenants or contracts, and, except that, if the Agency has not completed its housing obligations pursuant to Section 33413 of the Community Redevelopment Law, it shall retain its authority to implement its requirements under Section 33413, including its ability to incur and pay indebtedness for this purpose, and shall use this authority to complete these housing obligations as soon as reasonably possible.

ATTACHMENT 1

LAND USE PLAN AND LEGAL DESCRIPTION

All that certain real property situate in the City and County of San Francisco, State of California, more particularly described as follows:

Commencing at the intersection point of the northeasterly line of Sixth Street (82.50 feet wide) with the southeasterly line of Berry Street (82.50 feet wide), said intersection having a coordinate of north 468817.32, east 1451868.98 in the California Coordinate System of 1927, Zone 3; thence along said southeasterly line of Berry Street south 46 18' 07" west 990.05 feet to the southwesterly line of Seventh Street (82.50 feet wide); thence along said southwesterly line of Seventh Street south 43 41' 53" east 440.00 feet to the southeasterly line of Channel Street (200.00 feet wide), and being the true point of beginning; thence continuing along said southwesterly line of Seventh Street south 43 41' 53" east 2017.19 feet to the westerly line of Pennsylvania Street (90.00 feet wide); thence along said westerly line of Pennsylvania Street south 3 10' 56" east 600.92 feet to the southerly line of Mariposa Street (66.00 feet wide); thence along said southerly line of Mariposa Street north 86 49' 04" east 1690.17 feet to the westerly line of Illinois Street (80.00 feet wide); thence along said westerly line of Illinois Street south 3 10' 56" east 63.85 feet; thence north 86 49' 04" east 80.00 feet to a point on the easterly line of Illinois Street, last said point being on the Mission Bay Project boundary; thence along said Mission Bay Project boundary the following courses and distances; thence north 35 06' 05" east 616.30 feet; thence northeasterly along an arc of a curve to the left, tangent to the preceding course with a radius of 440.00 feet through a central angle of 12 49' 53" an arc distance of 98.54 feet; thence tangent to the preceding curve north 22 16' 12" east 700.07 feet; thence northerly along an arc of a curve to the left, tangent to the preceding course with a radius of 340.00 feet through a central angle of 12 28' 00" an arc distance of 73.98 feet; thence tangent to the preceding curve north 9 48' 12" east 86.42 feet; thence northerly along the arc of a curve to the left, tangent to the preceding course with a radius of 340.00 feet, through a central angle of 11 58' 09", an arc distance of 71.03 feet; thence tangent to the preceding curve north 2 09' 57" west 121.44 feet; thence north 3 10' 56" west 198.86 feet; thence north 2 19' 47" west 292.70 feet; thence northwesterly along an arc of a curve to the left, tangent to the preceding course with a radius of 481.57 feet through a central angle of 24 30' 49", an arc distance of 206.04 feet; thence tangent to the preceding curve north 26 50' 36" west 402.03 feet; thence northwesterly along an arc of a curve to the right, tangent to the preceding course with a radius of 236.29 feet, through a central angle of 9 00' 04" an arc distance of 37.12 feet; thence tangent to the preceding curve north 17 50' 32" west 679.08 feet; thence south 86 49' 04" west 282.38 feet; thence leaving said Mission Bay Project boundary south 17 34' 00" east 2.58 feet; thence south 86 49' 04" west 397.43 feet to the easterly line of Third Street (82.50 feet wide); thence along said easterly line of Third Street north 3 10' 56" west 1265.04 feet; thence south 64 21' 26" west 95.76 feet to the intersection of the westerly line of Third Street with said southeasterly line of Channel Street; thence along said southeasterly line of Channel Street south 46 18' 07" west 3578.74 feet to the true point of beginning.

Containing 10,356,710 square feet, more or less.

The bearings used in the above description are on the California Coordinate System of 1927, Zone 3. Multiply the above distances by 0.999928 to obtain grid distances.

ATTACHMENT 2

PLAN AREA MAP



Note: Street alignments and open space configurations shown on the figure are not exact and are indicated for illustrative purposes.

ATTACHMENT 3

REDEVELOPMENT LAND USE MAP

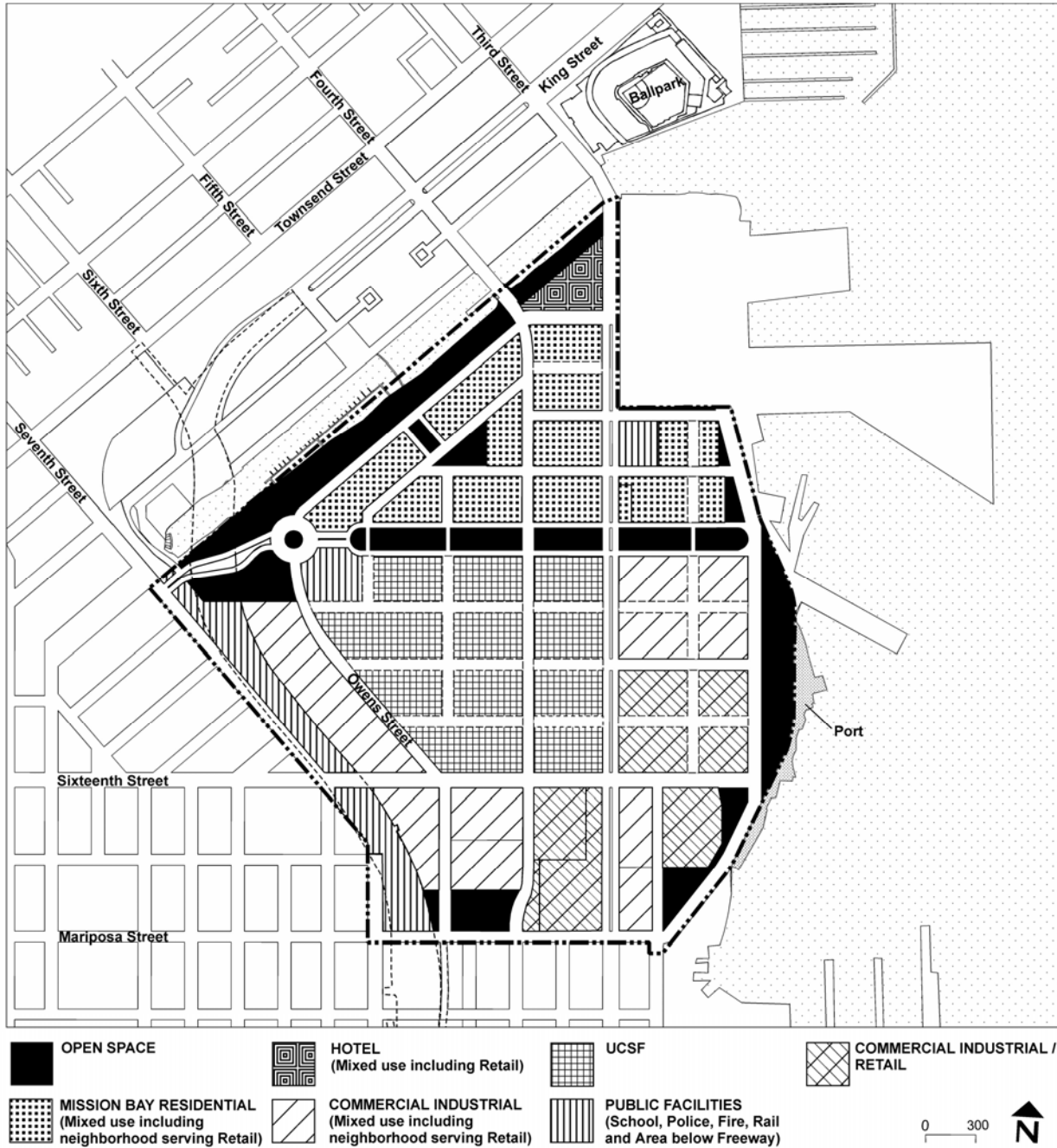

Note: Street alignments and open space configurations shown on the figure are not exact and are indicated for illustrative purposes.

ATTACHMENT 3a

ZONE MAP

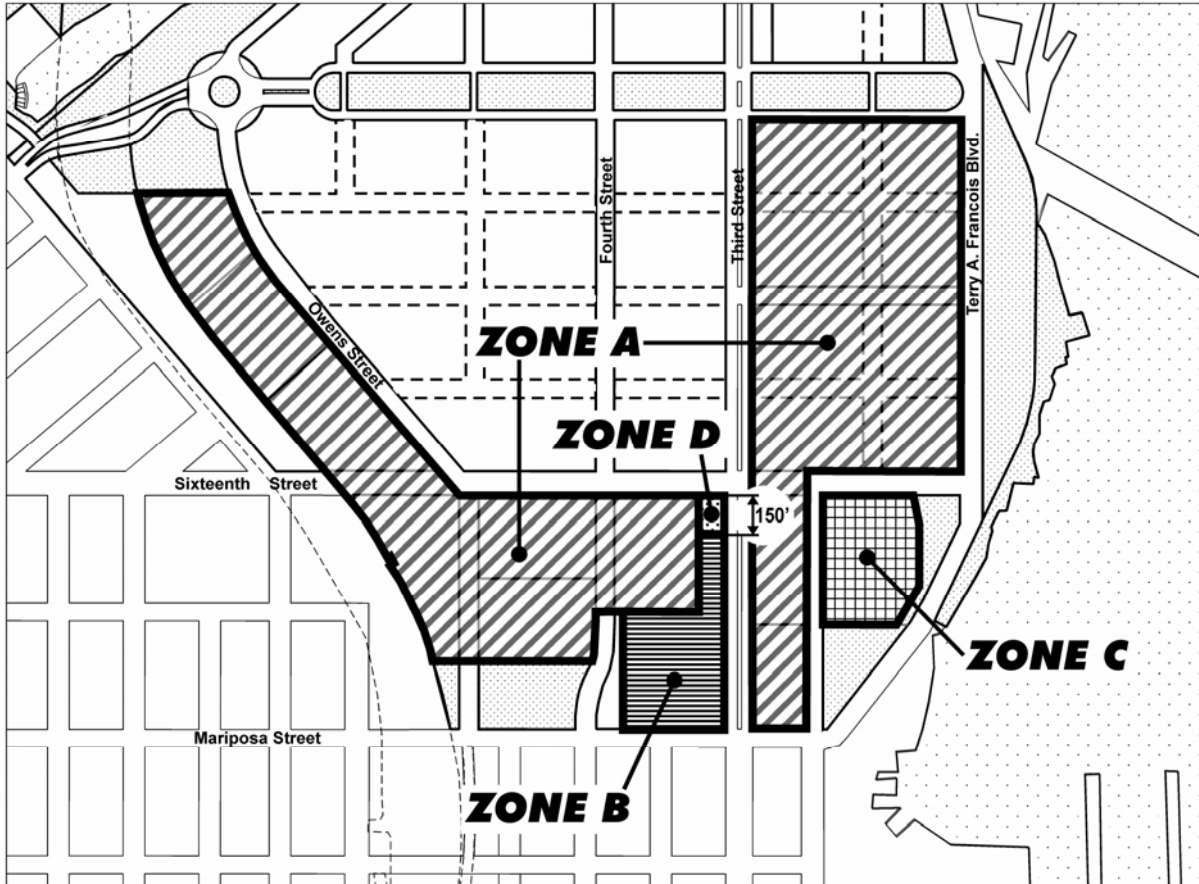

Note: Street alignments and open space configurations shown on the figure are not exact and are indicated for illustrative purposes.

ATTACHMENT 4

PROPOSED PUBLIC IMPROVEMENTS

Public roadways and other walkways, roadways, lanes and connections
Freeway improvements; such as bridge widenings and freeway ramp and related improvements
Median, curbs, gutters and sidewalks
Traffic signals, street signage and pavement striping
Street lighting
Landscaping (including street right-of-way landscaping)
Public open spaces, including plazas and parks
Functional and decorative facilities in parks and plazas such as fountains, bathrooms, benches, tables, trash receptacles, signage and landscaping
China Basin Channel and San Francisco Bay edge improvements and landscaping
Potable water distribution and fire suppression facilities (low pressure water and high pressure water)
Reclaimed and/or recycled water facilities
Combined and/or separated sanitary and storm sewer facilities (including pumping and treatment facilities)
Storm drains, pump stations facilities, treatment facilities and flood control facilities
Natural gas, electric telephone and telecommunications facilities
Utilities and utility relocations
Suction inlets along China Basin Channel or the San Francisco Bay for fire protection
Police and/or Fire Station structure and police and fire equipment and facilities
Pedestrian bridge across China Basin Channel
Structures for environmental investigations/testing/remediation in connection with roads, plazas, parks or other improvements
Water recirculation facilities
Rail facilities, signals, crossings and improvements
Islais Creek rail bridge and related improvements
Erosion control features related to public facilities
Improvements related to overland flows
MUNI light rail/bus/transit facilities and related improvements
Public school, school yard and related facilities
Additional temporary, interim and/or permanent facilities and improvements related to the foregoing

ATTACHMENT 5

DEFINITIONS

Following are definitions for certain words and terms used in this Plan. All words used in the present tense shall include the future. All words in the plural number shall include the singular number and all words in the singular number shall include the plural number, unless the natural construction of the wording indicates otherwise. The word “shall” is mandatory and not directory.

Adult Entertainment. An amusement and entertainment use which includes the following: adult bookstore, as defined by Section 791 of the San Francisco Police Code; adult theater, as defined by Section 791 of the Police Code; and encounter studio, as defined by Section 1072.1 of the Police Code, as in effect as of the date of adoption of this Plan.

Amusement Enterprise. An amusement and entertainment use which provides eleven or more amusement game devices such as video games, pinball machines or other such similar mechanical and electronic amusement devices, in a quantity which exceeds that specified in Section 1036.31 of the San Francisco Police Code, as in effect as of the date of adoption of this Plan, as accessory uses.

Animal Services. An animal care use which provides medical care and accessory boarding services for animals, not including a commercial kennel.

Arts Activities and Spaces. Arts activities shall include performance, exhibition (except exhibition of films), rehearsal, production, post-production and schools of any of the following: dance, music, dramatic art, film, video, graphic art, painting, drawing, sculpture, small-scale glass works, ceramics, textiles, woodworking, photography, custom-made jewelry or apparel, and other visual, performance and sound arts and crafts. It shall include commercial arts and art-related business service uses including, but not limited to, recording and editing services; small-scale film and video developing and printing; titling; video and film libraries; special effects production; fashion and photo stylists; production, sale and rental of theatrical wardrobes; and studio property production and rental companies. Art spaces shall include studios, workshops, galleries, museums, archives, and other similar spaces customarily used principally for arts activities, exclusive of Theaters, dance halls, and any other establishment where liquor is customarily served during performances.

Automobile Rental. A retail use which provides vehicle rentals whether conducted within a building or on an open lot.

Bar. A principal retail use not located in a Restaurant which provides on-site alcoholic beverage sales for drinking on the premises, including bars serving beer, wine and/or liquor to the customer where no person under 21 years of age is admitted (with Alcoholic Beverage Control “ABC” licenses 42, 48 or 61) and drinking establishments serving liquor (with ABC licenses 47 or 49) in conjunction with other uses which admit minors, such as theaters and other entertainment.

Building. Any structure having a roof supported by columns or walls, and intended for permanent occupancy.

Building Code. The City's Building Code, Electric Code, Mechanical Code and Plumbing Code and any construction requirements in the Housing Code and the Fire Code of the City (including the Port) and including H-8 occupancy for life science buildings and laboratories above the third floor permitted by the State of California Building Code.

Building Permit. A permit issued by the Central Permit Bureau of the City, which will allow the commencement of construction.

Business or Professional Service. An office use which provides to the general public, general business or professional services, including but not limited to, accounting, architectural, clerical, consulting, insurance, legal, management, real estate brokerage and travel services. It also includes business offices of building, electrical, furnace, painting, pest control, plumbing or roofing contractors, if no storage of equipment or items for wholesale use are located on-site. It may also include incidental accessory storage of office supplies and samples. Loading and unloading of all vehicles shall be located entirely within the building containing the use. It may provide services to the business community, provided that it also provides services to the general public. This use does not include research service of an industrial or scientific nature in a commercial or medical laboratory, other than routine medical testing and analysis by a health-care professional or hospital.

Catering Establishment. A home and business service, which involves the preparation and delivery of goods, such as the following items: food, beverages, balloons, flowers, plants, party decorations and favors, cigarettes and candy.

City Agency/Agencies. Includes all City departments, agencies, boards, commission and bureaus with subdivision or other permit, entitlement, or approval authority or jurisdiction over development within the Plan Area, or any portion thereof, including, without limitation, the Port Commission (the "Port"), the City Administrator, the Public Works Department, the Public Utilities Commission, the Planning Commission, the Public Transportation Commission, the Parking and Traffic Commission, the Building Inspection Commission, the Public Health Commission, the Fire Commission, and the Police Commission, together with any successor City Agency, department or officer designated by or pursuant to law.

City Regulations. Includes (i) those City land use codes, including those of its Port Commission (including, without limitation, the Planning and Subdivision Codes, the City General Plan and Waterfront Land Use Plan), (ii) those ordinances, rules, regulations and official policies adopted thereunder and (iii) all those ordinances, rules, regulations, official policies and plans governing zoning, subdivisions and subdivision design, land use, rate of development, density, building size, public improvements and dedications, construction standards, new construction and use, design standards, permit restrictions, development fees or exactions, terms and conditions of occupancy, or environmental guidelines or review, including those relating to hazardous substances, pertaining to the Plan Area, as adopted and amended by the City from time to time.

Developable Land Area. All areas within a lot including without limitation, private open space, private lanes, and private sidewalks; but excluding public streets and rights-of-way, and public open space.

Dwelling Unit. A room or suite of two or more rooms that is designed for residential occupancy for 32 consecutive days or more, with or without shared living spaces, such as kitchens, dining facilities or bathrooms.

Existing City Regulations. Those City Regulations in effect as of the date of adoption of this Plan.

Family Child Care Facility. A use in a residential unit, which provides less than 24-hour care for up to 12 children by licensed personnel and which meets the requirements of the State of California and other authorities.

Floor Area Ratio. The ratio of the Gross Floor Area of buildings to Developable Land Area, calculated as described in Section 304.5 for Commercial Industrial and Commercial Industrial/Retail areas. In cases in which portions of the Gross Floor Area of a building project horizontally beyond the lot lines, all such projecting Gross Floor Area shall also be included in determining the floor area ratio. If the height per story of a building, when all the stories are added together, exceeds an average of 18 feet, then additional Gross Floor Area shall be counted in determining the floor area ratio of the building, equal to the average Gross Floor Area of one additional story for each 18 feet or fraction thereof by which the total building height exceeds the number of stories times 18 feet; except that such additional Gross Floor Area shall not be counted in the case of Live/Work Units or a church, Theater or other place of public assembly.

Gross Floor Area. The sum of the gross areas of the several floors of a building or buildings, measured from the exterior faces of exterior walls or from the centerlines of walls separating two buildings. Where columns are outside and separated from an exterior wall (curtain wall) which encloses the building space or are otherwise so arranged that the curtain wall is clearly separate from the structural members, the exterior face of the curtain wall shall be the line of measurement, and the area of the columns themselves at each floor shall also be counted.

- (a) Except as specifically excluded in this definition, “gross floor area” shall include, although not be limited to, the following:
 - (1) Basement and cellar space, including tenants’ storage areas and all other space except that used only for storage or services necessary to the operation or maintenance of the building itself;
 - (2) Elevator shafts, stairwells, exit enclosures and smokeproof enclosures, at each floor;
 - (3) Floor space in penthouses except as specifically excluded in this definition;

- (4) Attic space (whether or not a floor has been laid) capable of being made into habitable space;
 - (5) Floor space in balconies or mezzanines in the interior of the building;
 - (6) Floor space in open or roofed porches, arcades or exterior balconies, if such porch, arcade or balcony is located above the ground floor or first floor of occupancy above basement or garage and is used as the primary access to the interior space it serves;
 - (7) Floor space in accessory buildings, except for floor spaces used for accessory off-street parking or loading spaces as described herein, and driveways and maneuvering areas incidental thereto; and
 - (8) Any other floor space not specifically excluded in this definition.
- (b) “Gross floor area” shall not include the following:
- (1) Basement and cellar space used only for storage or services necessary to the operation or maintenance of the building itself;
 - (2) Attic space not capable of being made into habitable space;
 - (3) Elevator or stair penthouses, accessory water tanks or cooling towers, and other mechanical equipment, appurtenances and areas necessary to the operation or maintenance of the building itself, if located at the top of the building or separated therefrom only by other space not included in the gross floor area;
 - (4) Mechanical equipment, appurtenances and areas, necessary to the operation or maintenance of the building itself if located at an intermediate story of the building and forming a complete floor level;
 - (5) Outside stairs to the first floor of occupancy at the face of the building which the stairs serve, or fire escapes;
 - (6) Floor space used for accessory off-street parking and loading spaces and driveways and maneuvering areas incidental thereto;
 - (7) Arcades, plazas, walkways, porches, breezeways, porticos and similar features (whether roofed or not), at or near street level, accessible to the general public and not substantially enclosed by exterior walls; and accessways to public transit lines, if open for use by the general public; all exclusive of areas devoted to sales, service, display, and other activities other than movement of persons;
 - (8) Balconies, porches, roof decks, terraces, courts and similar features, except those used for primary access as described in Paragraph (a)(6) above, provided that:

(A) If more than 70 percent of the perimeter of such an area is enclosed, either by building walls (exclusive of a railing or parapet not more than three feet eight inches high) or by such walls and interior lot lines, and the clear space is less than 15 feet in either dimension, the area shall not be excluded from gross floor area unless it is fully open to the sky (except for roof eaves, cornices or belt courses which project not more than two feet from the face of the building wall).

(B) If more than 70 percent of the perimeter of such an area is enclosed, either by building walls (exclusive of a railing or parapet not more than three feet eight inches high), or by such walls and interior lot lines, and the clear space is 15 feet or more in both dimensions, (1) the area shall be excluded from gross floor area if it is fully open to the sky (except for roof eaves, cornices or belt courses which project no more than two feet from the face of the building wall), and (2) the area may have roofed areas along its perimeter which are also excluded from gross floor area if the minimum clear open space between any such roof and the opposite wall or roof (whichever is closer) is maintained at 15 feet (with the above exceptions) and the roofed area does not exceed 10 feet in depth; (3) in addition, when the clear open area exceeds 625 square feet, a canopy, gazebo, or similar roofed structure without walls may cover up to 10 percent of such open space without being counted as gross floor area.

(C) If, however, 70 percent or less of the perimeter of such an area is enclosed by building walls (exclusive of a railing or parapet not more than three feet eight inches high) or by such walls and interior lot lines, and the open side or sides face on a yard, street or court, the area may be roofed to the extent permitted by such codes in instances in which required windows are involved;

(9) On lower, nonresidential floors, elevator shafts and other life-support systems serving exclusively the residential uses on the upper floors of a building;

(10) One-third of that portion of a window bay conforming to the requirements of Section 136(d)(2) of the San Francisco Planning Code (in effect as of the date of adoption of this Plan) which extends beyond the plane formed by the face of the facade on either side of the bay but not to exceed seven square feet per bay window as measured at each floor;

(11) Ground floor area devoted to building or pedestrian circulation and building service;

(12) Space devoted to personal services, Restaurants, and retail sales of goods intended to meet the convenience shopping and service needs of downtown workers and residents, not to exceed 5,000 occupied square feet per use and, in total, not to exceed 75 percent of the area of the ground floor of the building plus the ground level, on-site open space;

- (13) An interior space provided as an open space feature in accordance with the requirements herein;
- (14) Floor area devoted to child care facilities provided that:
 - (A) Allowable indoor space is no less than 3,000 square feet and no more than 6,000 square feet, and
 - (B) The facilities are made available rent free, and
 - (C) Adequate outdoor space is provided adjacent, or easily accessible, to the facility. Spaces such as atriums, rooftops or public parks may be used if they meet licensing requirements for child care facilities, and
 - (D) The space is used for child care for the life of the building as long as there is a demonstrated need. No change in use shall occur without a finding by the Redevelopment Agency that there is a lack of need for child care and that the space will be used for a facility described herein dealing with cultural, educational, recreational, religious, or social service facilities;
- (15) Floor area permanently devoted to cultural, educational, recreational, religious or social service facilities available to the general public at no cost or at a fee covering actual operating expenses, provided that such facilities are:
 - (A) Owned and operated by a nonprofit corporation or institution, or
 - (B) Are made available rent-free for occupancy only by nonprofit corporations or institutions for such functions. Building area subject to this subsection shall be counted as occupied floor area, except as provided herein, for the purpose of calculating the off-street parking and freight loading requirements;
 - (C) For the purpose of calculating the off-street parking and freight loading requirement for the project, building area subject to this subsection shall be counted as occupied floor area, except as provided herein.

Home Occupation. A work-related use in a Dwelling Unit intended for sole proprietor businesses.

Leasable Floor Area. The Floor Rentable Area, as defined and calculated in the 1996 Building Owners and Managers Association International publication “Standard Method for Measuring Floor Area in Office Buildings.”

Live/Work Unit. A building or portion of a building combining residential living space with an integrated work space principally used by one or more of the residents. Live/work Units are subject to the same land use controls as Dwelling Units.

Local-Serving Business. A local-serving business provides goods and/or services which are needed by residents and workers in the immediately surrounding neighborhood to satisfy basic personal and household needs on a frequent and recurring basis, and which if not available would require trips outside of the neighborhood. Also referred to as “neighborhood-serving” business.

Local-Serving Child Care Facility. A local-serving institutional use, which provides less than 24-hour care for children by licensed personnel and which meets the requirements of the State of California and other authorities. Such use is local-serving in that it serves primarily residents and workers of the immediately surrounding neighborhood on a frequent and recurring basis, and which if not available would require trips outside of the neighborhood.

Nighttime Entertainment. An assembly and entertainment use that includes dance halls, discotheques, nightclubs, private clubs, and other similar evening-oriented entertainment activities, excluding Adult Entertainment, which require dance hall keeper police permits or place of entertainment police permits which are not limited to non-amplified live entertainment, including Restaurants and Bars which present such activities, but shall not include any arts activities or spaces as defined by this Plan, any Theater performance space which does not serve alcoholic beverages during performances, or any temporary uses permitted by this Plan.

Office Use. A space within a structure intended or primarily suitable for occupancy by persons or entities which perform for their own benefit or provide to others at that location, administrative services, design services, business and professional services, financial services or medical services, excluding office space and administrative uses associated with Manufacturing, as described in Sections 302.3 and 302.4, above.

Open Air Sales. A retail use involving open air sale of new and/or used merchandise, except vehicles, but including agricultural products, crafts, and/or art work.

Open Recreation. An area, not within a building, which is provided for the recreational uses of patrons of a commercial establishment.

Outdoor Activity Area. An area, not including primary circulation space or any public street, located outside of a building or in a courtyard which is provided for the use or convenience of patrons of a commercial establishment including, but not limited to, sitting, eating, drinking, dancing, and food-service activities.

Parking. A parking facility serving uses located on either parcels or blocks occupied by said facility or on other parcels or blocks.

Plan Documents. This Plan and its implementing documents including, without limitation, any owner participation agreements, the Mission Bay North Design for Development and the Mission Bay Subdivision Ordinance and regulations adopted thereunder.

Restaurant. A full service or self-service retail facility primarily for eating use which provides ready-to-eat food to customers for consumption on or off the premises, which may or may not

provide seating, and which may include a Bar. Food may be cooked or otherwise prepared on the premises.

Retail Sales and Services. A commercial use which provides goods and/or services directly to the customer including Outdoor Activity Areas and Open Air Sales Areas. It may provide goods and/or services to the business community, provided that it also serves the general public.

Storage. A use which stores goods and materials used by households or businesses at other locations, but which does not include junk, waste, salvaged materials, automobiles, inflammable or highly combustible materials. A storage building for household or business goods may be operated on a self-serve basis.

Theater. An assembly and entertainment use other than Adult Entertainment, which displays motion pictures, slides, or closed-circuit television pictures, or is used as live theater performance space.

Walk-Up Facility. A structure designed for provision of pedestrian-oriented services, located on an exterior building wall, including window service, self-service operations, and automated bank teller machines (“ATMs”).

ATTACHMENT 6

PLANNING COMMISSION RESOLUTION